

# CENTURY TOOL & DESIGN, Inc.

2024

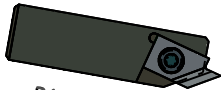

YOUR SCREW MACHINE TOOLING SPECIALISTS.  
GET BETTER MACHINING RESULTS.  
OFFERING A COMPLETE DESIGN AND BUILD ON  
INSERTED STYLE TOOLING.



PAGES 6-7

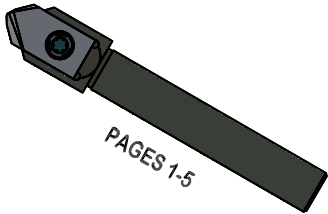

PAGES 1-5

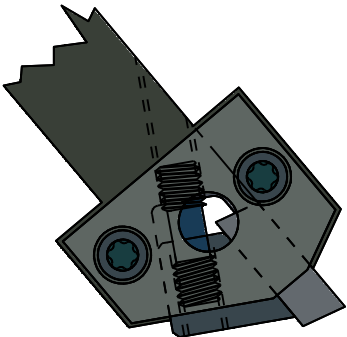

PAGES 27-30

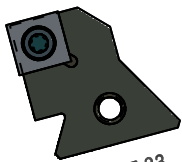

PAGE 33

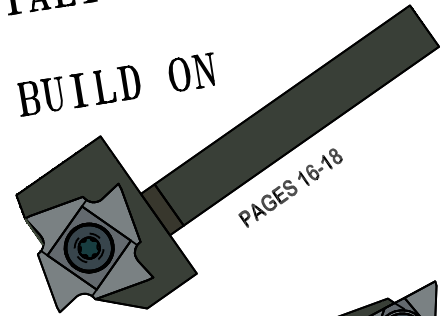
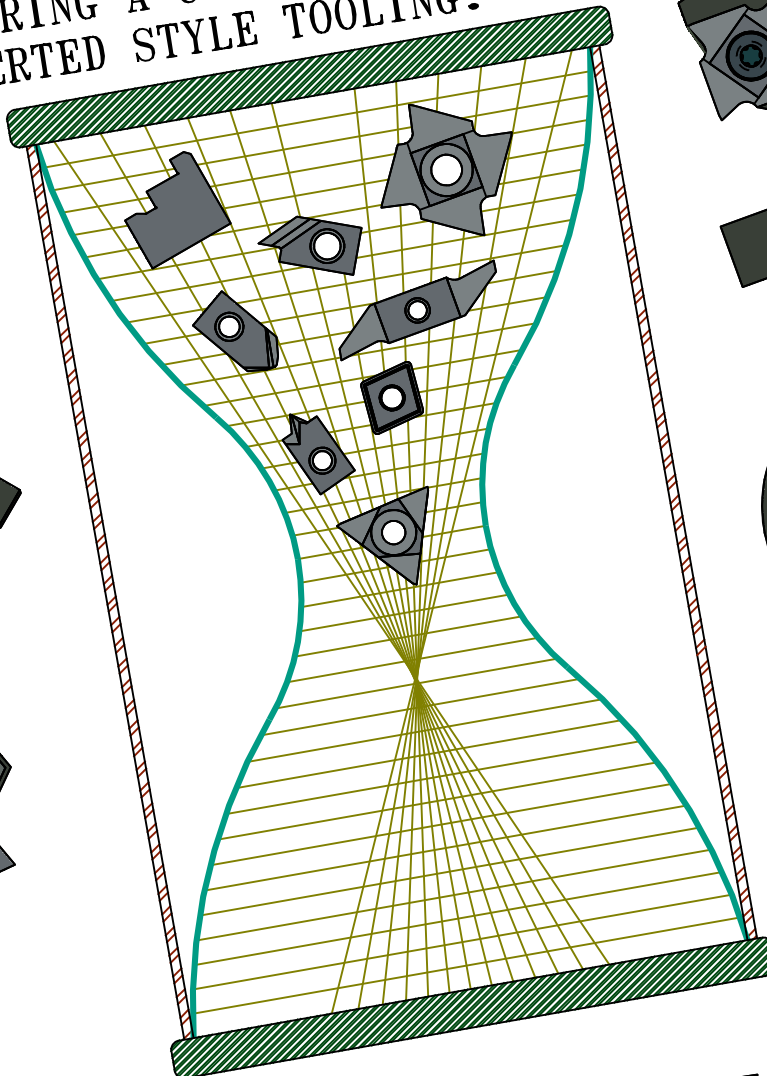

PAGES 16-18



PAGES 19-22

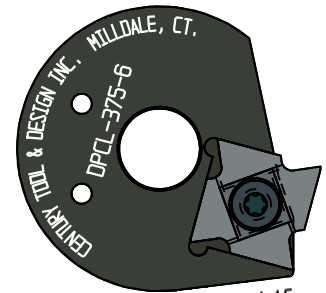

PAGE 14-15

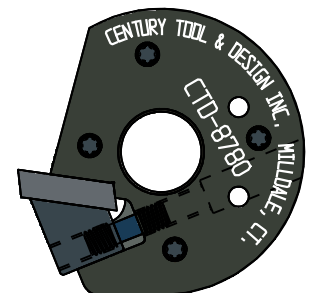

PAGE 31



PAGES 23-26

CENTURY TOOL & DESIGN, INC. • 260 CANAL STREET • P.O. BOX 545 • MILLDALE, CT 06467  
PHONE: 860-621-6748 • 1-800-229-2368 • FAX: 860-621-1030  
EMAIL: CENTURY@CENTTOOL.COM • WWW.CENTTOOL.COM

REVISED 02/01/2024

Volume 29

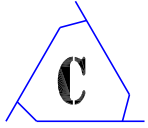

# CENTURY TOOL & DESIGN INC.

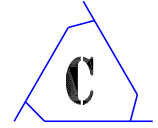

## INDEXABLE CARBIDE INSERTS:

SQUARE Cut Off Inserts - FOUR CUTTING EDGES

TRIANGULAR Cut Off Inserts - THREE CUTTING EDGES

STICK Style Inserts - TWO CUTTING EDGES

## END WORKING CARBIDE INSERTS:

Combined Spot Drill & Countersink Inserts

Spot Drill Inserts

Countersink Inserts

## WEDGE-LOC™ CARBIDE INSERTS:

All WEDGE-LOC™ Inserts Are Regrindable

## TECHNICAL INFORMATION:

- \* LONGER TOOL LIFE
- \* MINIMUM DOWN TIME
- \* CONSISTENT QUALITY
- \* SIMPLIFIES TRAINING
- \* REPEATABILITY WITHIN .001
- \* MOST INSERTS ARE AVAILABLE RIGHT OR LEFT HAND
- \* CARBIDE INSERTS ARE MICRO-GRAIN CARBIDE
- \* MOST INSERTS ARE AVAILABLE IN T-15PM H.S.S.
- \* ALL INSERTS ARE AVAILABLE WITH NUMEROUS COATING OPTIONS. CALL FOR PRICE AND DELIVERY.
- \* MOST INSERTS ARE AVAILABLE WITH GRIND AFTER COAT, DESIGNATED WITH A "G" AFTER THE TOOL No.

EXAMPLE: SLPR-094-0-0-G TIALN

# CENTURY TOOL & DESIGN INC.

ESTABLISHED IN 1975. WE OFFER 49 YEARS OF EXPERIENCE SUPPLYING CNC, SWISS AND OTHER PRODUCTION MACHINERY WITH HOLDERS AND INSERTS. WE CARRY A STANDARD LINE AS WELL AS DESIGNING TOOLING FOR YOUR SPECIAL PROJECTS.

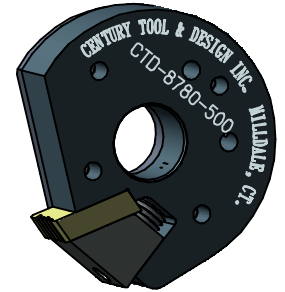
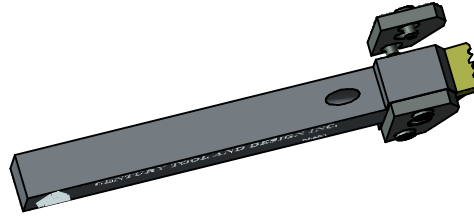
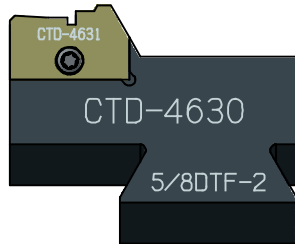

FORM TOOLING

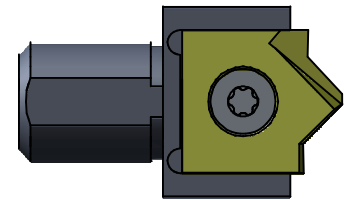
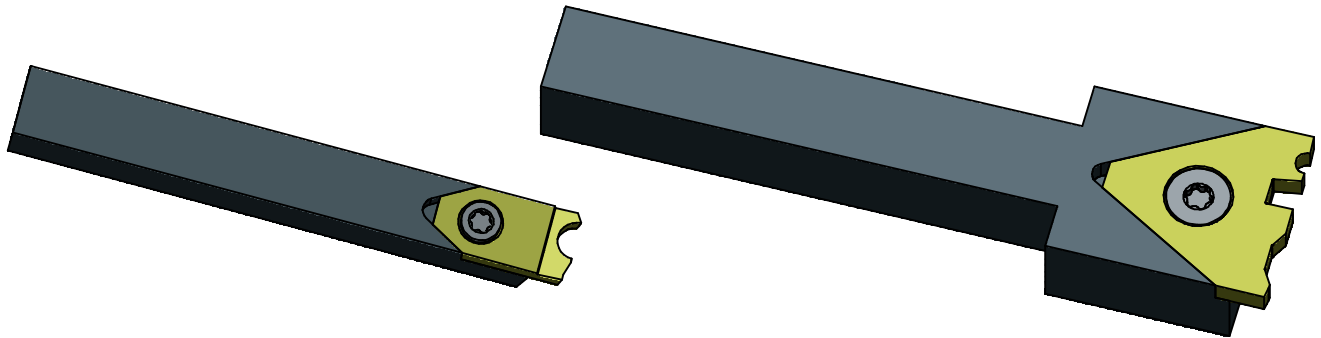

SPOT DRILL TOOLING

COUNTERSINK TOOLING

SPOT DRILL AND FACING

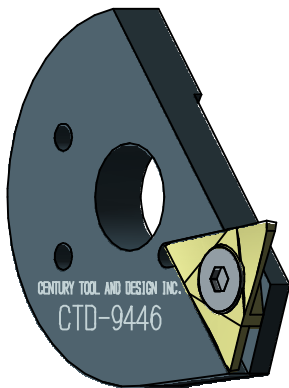

CUT-OFF TOOLING

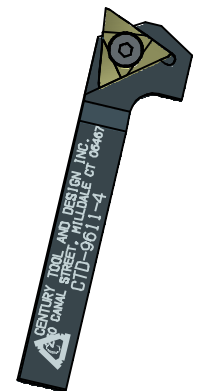

WWW.CENTTOOL.COM OR CONTACT US  
DIRECT AT 1-800-229-2368

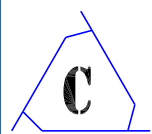

# INSERTED SPOT DRILL CENTER CUTTING INSERTS

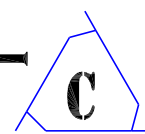

## TWO FLUTE RADIAL RELIEF SPOT DRILL INSERTS

PATENT No. 7540-696

.010 to .150 Outside Diameter

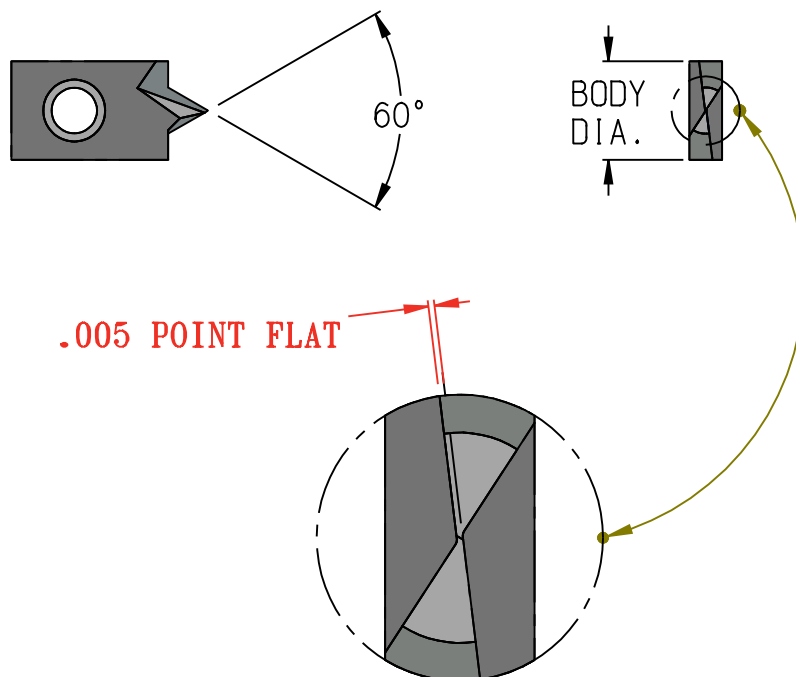

60° INSERTS		Right Hand Shown	
PLAIN TYPE	INSERT No.	POINT FLAT	BODY DIA.
#2	RSDI-2-60-005	.005	.250
#3	RSDI-3-60-005	.005	.375

### 60° INCLUDED RADIAL SPOT DRILL INSERT ADVANTAGES

USE SDH HOLDERS ON PAGE 3

- 1) THE 60° INCLUDED ANGLE HAS RADIAL AND CONICAL RELIEF THAT IS OFFSET TO GIVE THE CUTTING EDGE MAXIMUM STRENGTH PLUS CLEARANCE.
- 2) THESE TWO SPOT DRILL INSERTS ARE CENTER CUTTING WITH THE ABILITY TO SPOT MATERIAL STARTING WITH A OUTSIDE DIAMETER OF .010.
- 3) THE SPEEDS FOR THESE TWO INSERTS NEED TO BE BETWEEN 5000 R.P.M. AND 8000 R.P.M. PLUS THE FEED RATE SHOULD BE BETWEEN .500 AND 1.000 INCH PER MINUTE.

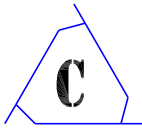

# INSERTED SPOT DRILL CENTER CUTTING INSERTS

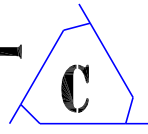

## TWO FLUTE STANDARD RELIEF SPOT DRILL INSERTS

" SPADE TYPE SPOT DRILL INSERTS AVAILABLE UPON REQUEST "

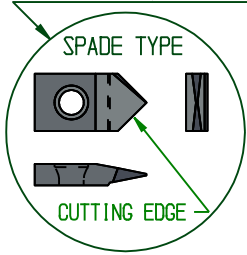

PATENT No. 7540-696

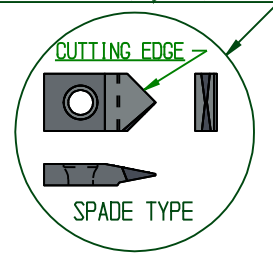

LETTER DESIGNATION	POINT FLAT
F = FINE POINT FLAT	.005
M = MEDIUM POINT FLAT	.015
H = HEAVY POINT FLAT	.034

Left Hand

Ordering EXAMPLE  
SDI-2-82-F-LH

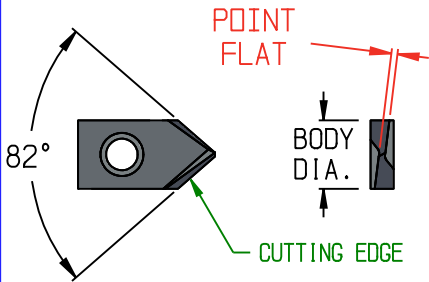

### 82° INSERTS

PLAIN TYPE	INSERT No.	POINT FLAT	ADD -LH FOR LEFT HAND	BODY DIA.
#2	SDI-2-82	F / M / H	SEE EXAMPLE	.250
#3	SDI-3-82	F / M / H	SEE EXAMPLE	.375
#4	SDI-4-82	F / M / H	SEE EXAMPLE	.500

Right Hand

Ordering EXAMPLE  
SDI-2-82-F

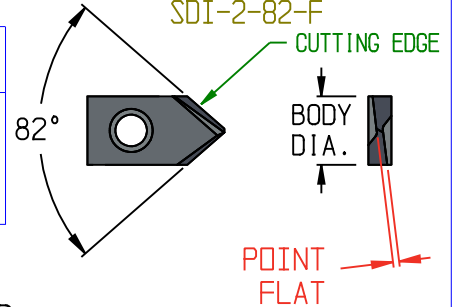

Left Hand

Ordering EXAMPLE  
SDI-3-90-M-LH

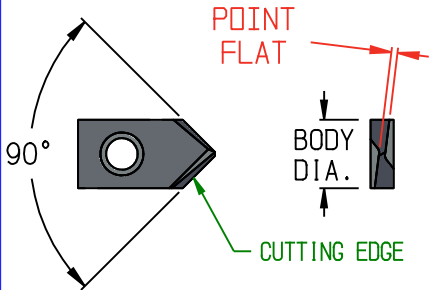

### 90° INSERTS

PLAIN TYPE	INSERT No.	POINT FLAT	ADD -LH FOR LEFT HAND	BODY DIA.
#2	SDI-2-90	F / M / H	SEE EXAMPLE	.250
#3	SDI-3-90	F / M / H	SEE EXAMPLE	.375
#4	SDI-4-90	F / M / H	SEE EXAMPLE	.500

Right Hand

Ordering EXAMPLE  
SDI-3-90-M

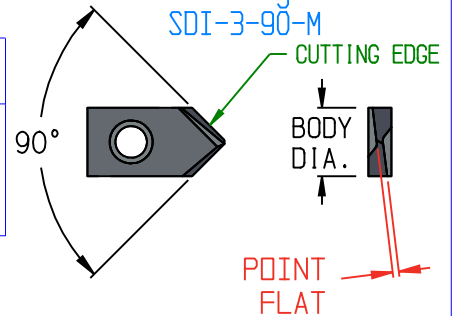

Left Hand

Ordering EXAMPLE  
SDI-4-120-H-LH

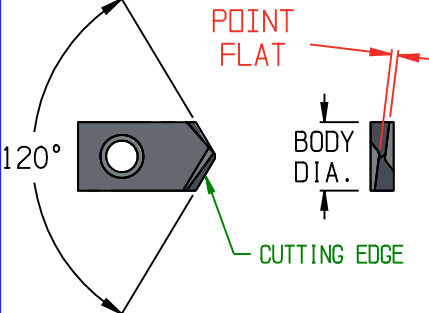

### 120° INSERTS

PLAIN TYPE	INSERT No.	POINT FLAT	ADD -LH FOR LEFT HAND	BODY DIA.
#2	SDI-2-120	F / M / H	SEE EXAMPLE	.250
#3	SDI-3-120	F / M / H	SEE EXAMPLE	.375
#4	SDI-4-120	F / M / H	SEE EXAMPLE	.500

Right Hand

Ordering EXAMPLE  
SDI-4-120-H

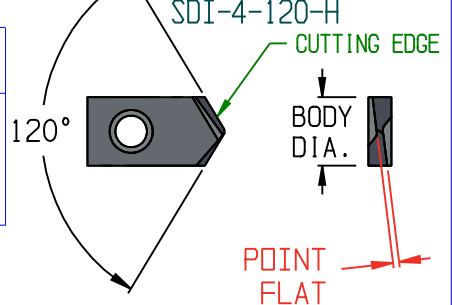

SEE PAGE #3 FOR HOLDERS

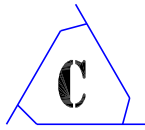

# INSERTED SPOT DRILL TOOLHOLDERS

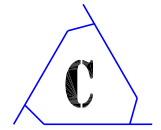

PATENT No. 7540-696

SEE INSERTS PAGES #1, #2.

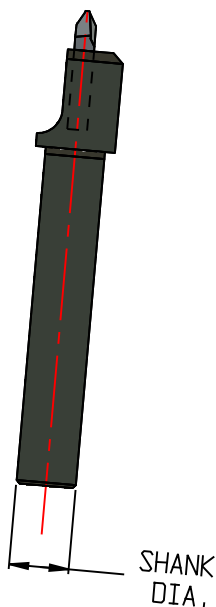
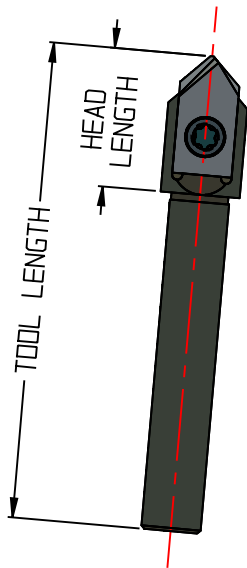
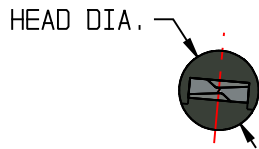

## PLAIN TYPE # 2

TOOLHOLDER No.	TOOL LENGTH	SHANK DIA.	HEAD DIA.	HEAD LENGTH	SCREW No.	WRENCH No.
SDH-2-250-2.0	2.0	.250	.405	.690	CTD-3126	CTD-3344
SDH-2-375-1.5	1.5	.375	-----	-----	CTD-3126	CTD-3344
SDH-2-375-2.5	2.5	.375	-----	-----	CTD-3126	CTD-3344
SDH-2-500-2.0	2.0	.500	-----	-----	CTD-3126	CTD-3344
SDH-2-500-3.0	3.0	.500	-----	-----	CTD-3126	CTD-3344
SDH-2-625-5.0	5.0	.625	-----	-----	CTD-3126	CTD-3344
SDH-2-750-5.0	5.0	.750	-----	-----	CTD-3126	CTD-3344
SDH-2-1.000-5.0	5.0	1.000	-----	-----	CTD-3126	CTD-3344
SDH-2-10MM-1.5	1.5	10MM	-----	-----	CTD-3126	CTD-3344
SDH-2-10MM-2.5	2.5	10MM	-----	-----	CTD-3126	CTD-3344

## PLAIN TYPE # 3

TOOLHOLDER No.	TOOL LENGTH	SHANK DIA.	HEAD DIA.	HEAD LENGTH	SCREW No.	WRENCH No.
SDH-3-375-2.0	2.0	.375	.625	.900	CTD-4110	CTD-4112
SDH-3-375-3.0	3.0	.375	.625	.900	CTD-4110	CTD-4112
SDH-3-500-2.0	2.0	.500	.625	.900	CTD-4110	CTD-4112
SDH-3-500-3.0	3.0	.500	.625	.900	CTD-4110	CTD-4112
SDH-3-625-3.0	3.0	.625	-----	-----	CTD-4110	CTD-4112
SDH-3-625-5.0	5.0	.625	-----	-----	CTD-4110	CTD-4112
SDH-3-750-3.5	3.5	.750	-----	-----	CTD-4110	CTD-4112
SDH-3-750-5.0	5.0	.750	-----	-----	CTD-4110	CTD-4112
SDH-3-1.000-5.0	5.0	1.000	-----	-----	CTD-4110	CTD-4112
SDH-3-10MM-2.0	2.0	10MM	.500	.900	CTD-4110	CTD-4112
SDH-3-10MM-3.0	3.0	10MM	.500	.900	CTD-4110	CTD-4112
SDH-3-16MM-3.0	3.0	16MM	-----	-----	CTD-4110	CTD-4112

## PLAIN TYPE # 4

TOOLHOLDER No.	TOOL LENGTH	SHANK DIA.	HEAD DIA.	HEAD LENGTH	SCREW No.	WRENCH No.
SDH-4-375-3.5	3.5	.375	.750	1.20	CTD-4111	CTD-4112
SDH-4-500-2.5	2.5	.500	.750	1.20	CTD-4111	CTD-4112
SDH-4-500-3.5	3.5	.500	.750	1.20	CTD-4111	CTD-4112
SDH-4-625-2.5	2.5	.625	.750	1.20	CTD-4111	CTD-4112
SDH-4-625-3.5	3.5	.625	.750	1.20	CTD-4111	CTD-4112
SDH-4-625-5.0	5.0	.625	.750	1.20	CTD-4111	CTD-4112
SDH-4-750-2.5	2.5	.750	-----	-----	CTD-4111	CTD-4112
SDH-4-750-3.5	3.5	.750	-----	-----	CTD-4111	CTD-4112
SDH-4-750-5.0	5.0	.750	-----	-----	CTD-4111	CTD-4112
SDH-4-1.000-5.0	5.0	1.000	-----	-----	CTD-4111	CTD-4112

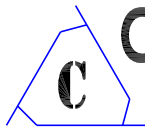

# COMBINED SPOT DRILL & COUNTERSINK INSERTS

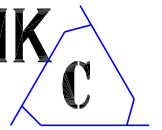

## TWO FLUTE STANDARD RELIEF - CENTER CUTTING INSERTS

PATENT No. 7540-696

SEE PAGE #5 FOR HOLDERS

### 60° INSERTS

Left Hand Shown

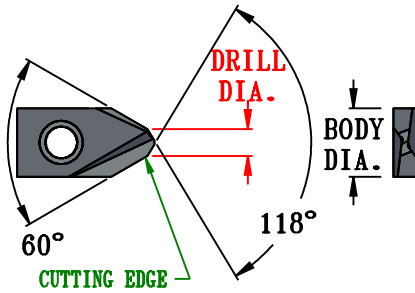

LEFT HAND INSERT No.	PLAIN TYPE	DRILL DIA.	BODY DIA.	RIGHT HAND INSERT No.
CDI-2-60-LH	#3	.109	.250	CDI-2-60
CDI-2.5-60-LH	#4	.125	.312	CDI-2.5-60
CDI-3.5-60-LH	#5	.187	.437	CDI-3.5-60
CDI-4-60-LH	#6	.218	.500	CDI-4-60

Right Hand Shown

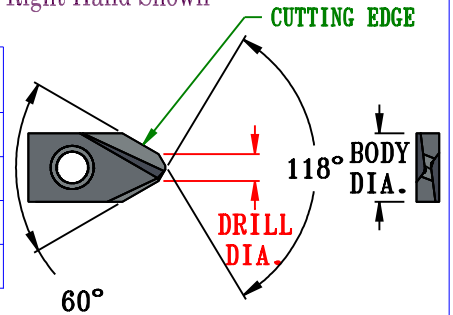

Left Hand Shown

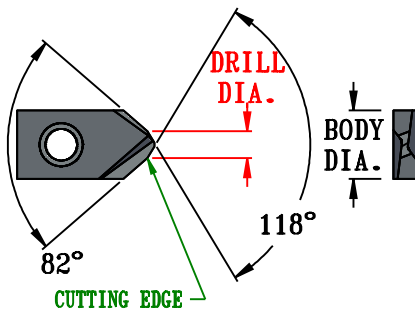

### 82° INSERTS

LEFT HAND INSERT No.	PLAIN TYPE	DRILL DIA.	BODY DIA.	RIGHT HAND INSERT No.
CDI-2-82-LH	#3	.109	.250	CDI-2-82
CDI-2.5-82-LH	#4	.125	.312	CDI-2.5-82
CDI-3.5-82-LH	#5	.187	.437	CDI-3.5-82
CDI-4-82-LH	#6	.218	.500	CDI-4-82

Right Hand Shown

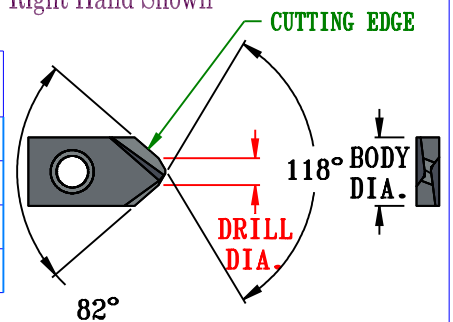

Left Hand Shown

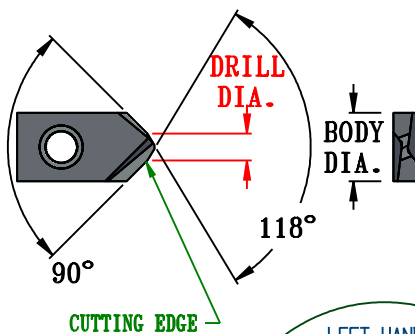

### 90° INSERTS

LEFT HAND INSERT No.	PLAIN TYPE	DRILL DIA.	BODY DIA.	RIGHT HAND INSERT No.
CDI-2-90-LH	#3	.109	.250	CDI-2-90
CDI-2.5-90-LH	#4	.125	.312	CDI-2.5-90
CDI-3.5-90-LH	#5	.187	.437	CDI-3.5-90
CDI-4-90-LH	#6	.218	.500	CDI-4-90

Right Hand Shown

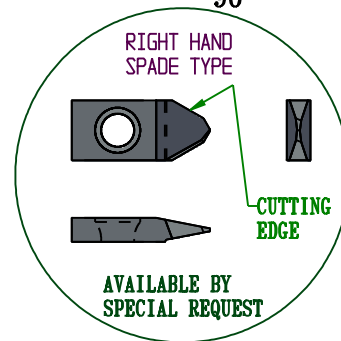
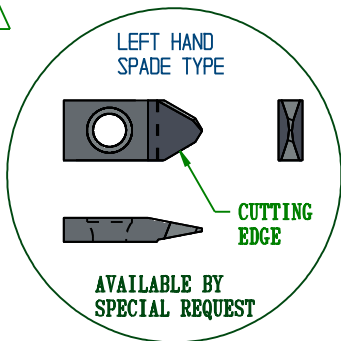
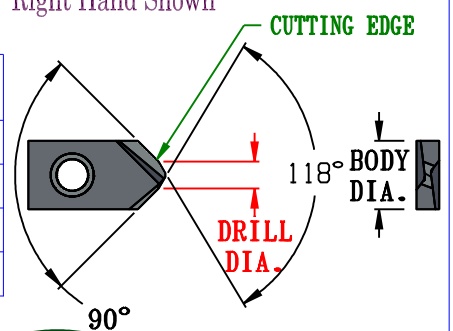

# COMBINED SPOT DRILL & COUNTERSINK TOOLHOLDERS

PATENT No. 7540-696

SEE INSERTS ON PAGE #4

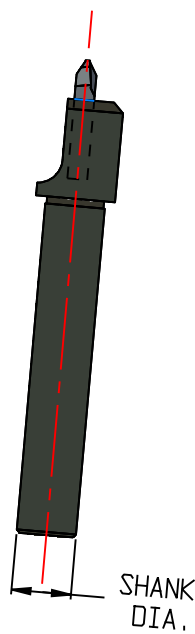
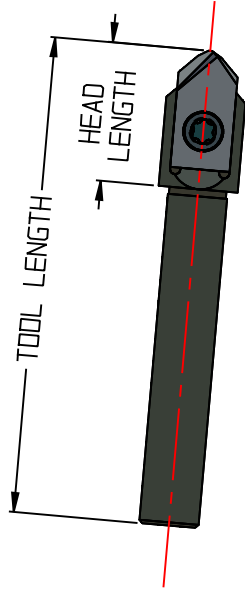
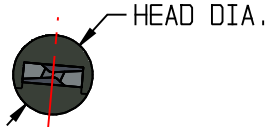
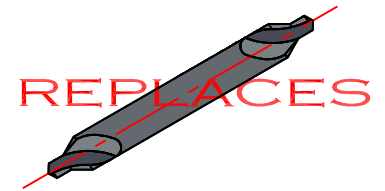

## PLAIN TYPE # 3

TOOLHOLDER No.	TOOL LENGTH	SHANK DIA.	HEAD DIA.	HEAD LENGTH	SCREW No.	WRENCH No.
CDH-2-375-1.5	1.5	.375	.375	-----	CTD-3126	CTD-3344
CDH-2-375-2.5	2.5	.375	.375	-----	CTD-3126	CTD-3344
CDH-2-500-1.5	1.5	.500	.500	-----	CTD-3126	CTD-3344
CDH-2-500-2.5	2.5	.500	.500	-----	CTD-3126	CTD-3344
CDH-2-10MM-1.5	1.5	10MM	10MM	-----	CTD-3126	CTD-3344
CDH-2-10MM-2.5	2.5	10MM	10MM	-----	CTD-3126	CTD-3344

## PLAIN TYPE # 4

TOOLHOLDER No.	TOOL LENGTH	SHANK DIA.	HEAD DIA.	HEAD LENGTH	SCREW No.	WRENCH No.
CDH-2.5-375-2.0	2.0	.375	.500	1.100	CTD-4110	CTD-4112
CDH-2.5-375-3.0	3.0	.375	.500	1.100	CTD-4110	CTD-4112
CDH-2.5-500-2.0	2.0	.500	-----	-----	CTD-4110	CTD-4112
CDH-2.5-500-3.0	3.0	.500	-----	-----	CTD-4110	CTD-4112
CDH-2.5-10MM-2.0	2.0	10MM	.500	1.100	CTD-4110	CTD-4112
CDH-2.5-10MM-3.0	3.0	10MM	.500	1.100	CTD-4110	CTD-4112

## PLAIN TYPE # 5

TOOLHOLDER No.	TOOL LENGTH	SHANK DIA.	HEAD DIA.	HEAD LENGTH	SCREW No.	WRENCH No.
CDH-3.5-375-2.0	2.0	.375	.750	1.100	CTD-4111	CTD-4112
CDH-3.5-375-3.0	3.0	.375	.750	1.100	CTD-4111	CTD-4112
CDH-3.5-500-2.0	2.0	.500	.750	1.100	CTD-4111	CTD-4112
CDH-3.5-500-3.0	3.0	.500	.750	1.100	CTD-4111	CTD-4112
CDH-3.5-10MM-2.0	2.0	10MM	.750	1.100	CTD-4111	CTD-4112
CDH-3.5-10MM-3.0	3.0	10MM	.750	1.100	CTD-4111	CTD-4112

## PLAIN TYPE # 6

TOOLHOLDER No.	TOOL LENGTH	SHANK DIA.	HEAD DIA.	HEAD LENGTH	SCREW No.	WRENCH No.
CDH-4-500-2.5	2.5	.500	.750	1.200	CTD-4111	CTD-4112
CDH-4-500-3.5	3.5	.500	.750	1.200	CTD-4111	CTD-4112
CDH-4-625-2.5	2.5	.625	.750	1.200	CTD-4111	CTD-4112
CDH-4-625-3.5	3.5	.625	.750	1.200	CTD-4111	CTD-4112
CDH-4-750-2.5	2.5	.750	.750	-----	CTD-4111	CTD-4112
CDH-4-750-3.5	3.5	.750	.750	-----	CTD-4111	CTD-4112



# INSERTABLE COUNTERSINK INSERTS

PATENT Nos. D396,865 & 5,827,019

SEE PAGE #7 FOR STANDARD HOLDERS

## LEFT HAND INSERTS

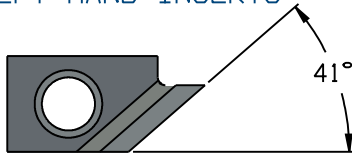

41° INSERTS	
L.H. INSERT No.	R.H. INSERT No.
CSI-41	CSI-41R

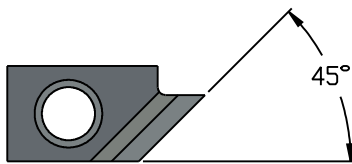

45° INSERTS	
L.H. INSERT No.	R.H. INSERT No.
CSI-45	CSI-45R

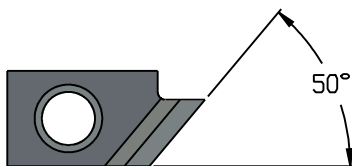

50° INSERTS	
L.H. INSERT No.	R.H. INSERT No.
CSI-50	CSI-50R

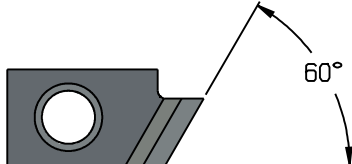

60° INSERTS	
L.H. INSERT No.	R.H. INSERT No.
CSI-60	CSI-60R

## RIGHT HAND INSERTS

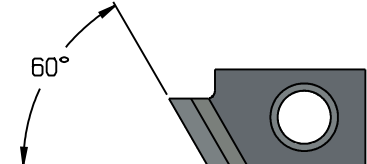
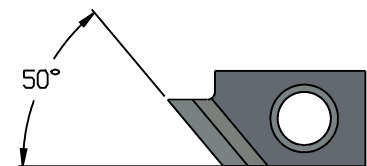
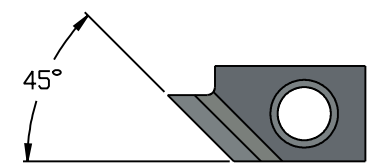
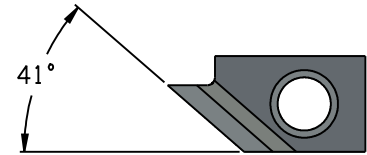

## STANDARD INSERTS IN SPECIAL TOOLHOLDERS

CREATE ANY INCLUDED ANGLE AND DIAMETER WITH A SPECIAL HOLDER,  
USING A STANDARD INSERT, DESIGNED TO YOUR SPECIFICATIONS.

### SAMPLES

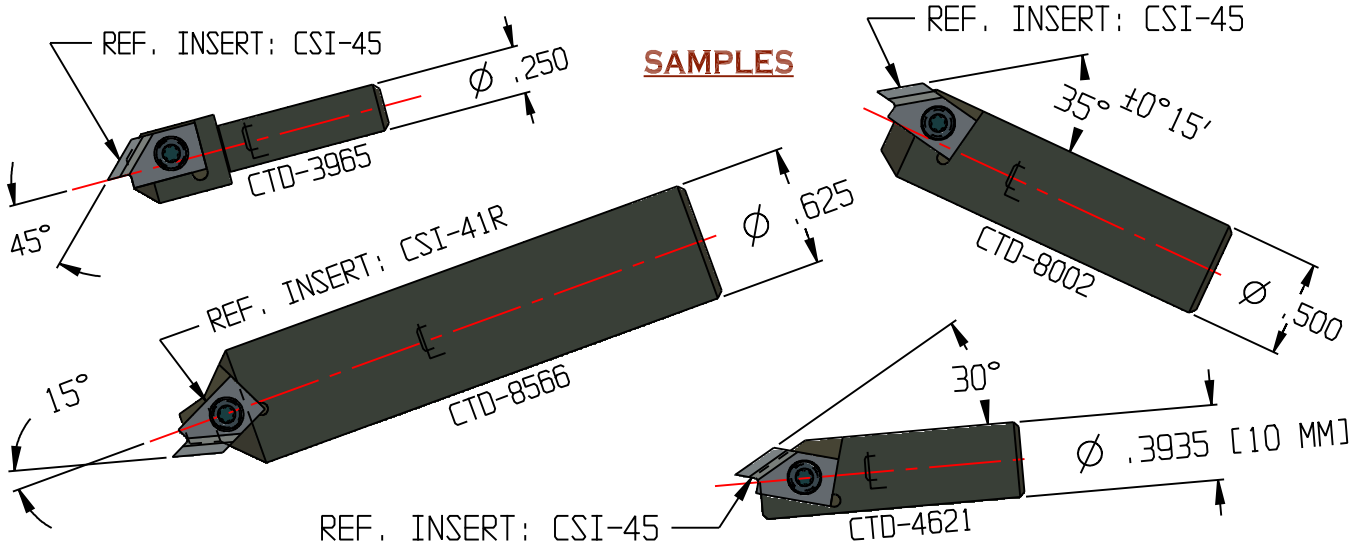

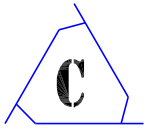

# INSERTED COUNTERSINK TOOLHOLDERS

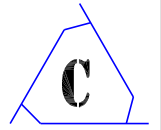

PATENT Nos. D396,865 & 5,827,019

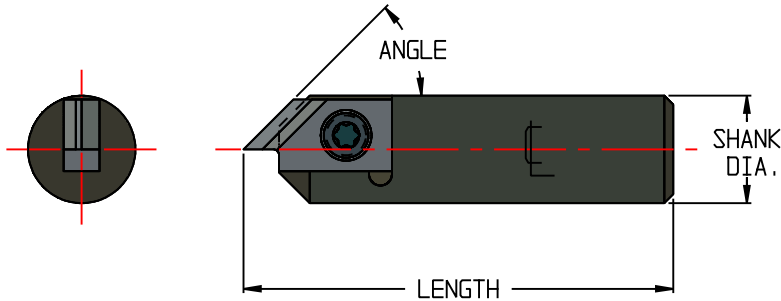

SEE INSERTS ON PAGE #6

## FEATURES

- \* COUNTERSINK RANGE FROM  $\varnothing$ .035 TO  $\varnothing$ .325
- \* BACKWORKING LEFT OR RIGHT HAND CUTTING
- \* CHAMFERING BACK END OF PART I.D.
- \* THREE OTHER LENGTHS ARE AVAILABLE AS STANDARDS. 1.0, 2.0, 2.5. ORDERING EXAMPLE CSH-90-500-1.0, CSH-90-500-2.0, CSH-90-500-2.5
- \* SPECIAL ORDER LENGTHS ARE AVAILABLE FOR HOLDERS ON THIS PAGE.
- \* SPECIAL HOLDERS CAN BE MADE TO ACCOMMODATE LARGER PART COUNTERSINK DIAMETER RANGES

LEFT HAND		LEFT HAND SHOWN					
INCLUDED ANGLE	TOOLHOLDER No.	TOOL LENGTH	SHANK DIA.	INSERT ANGLE	INSERT NO.	SCREW No.	WRENCH No.
82°	CSH-90-375	1.5	.375	41°	CSI-41	CTD-3126	CTD-3344
90°	CSH-90-375	1.5	.375	45°	CSI-45	CTD-3126	CTD-3344
100°	CSH-90-375	1.5	.375	50°	CSI-50	CTD-3126	CTD-3344
120°	CSH-120-375	1.5	.375	60°	CSI-60	CTD-3126	CTD-3344
90°	CSH-90-437	1.5	.4375	45°	CSI-45	CTD-3126	CTD-3344
82°	CSH-90-500	1.5	.500	41°	CSI-41	CTD-3126	CTD-3344
90°	CSH-90-500	1.5	.500	45°	CSI-45	CTD-3126	CTD-3344
100°	CSH-90-500	1.5	.500	50°	CSI-50	CTD-3126	CTD-3344
120°	CSH-120-500	1.5	.500	60°	CSI-60	CTD-3126	CTD-3344
90°	CSH-90-625	1.5	.625	45°	CSI-45	CTD-3126	CTD-3344
90°	CSH-90-750	1.5	.750	45°	CSI-45	CTD-3126	CTD-3344
90°	CSH-90-10MM	1.5	.3937	45°	CSI-45	CTD-3126	CTD-3344

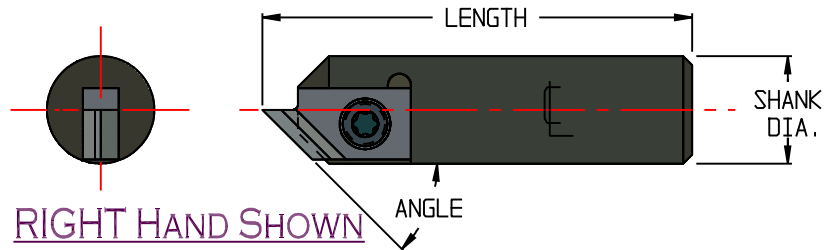

SEE INSERTS ON PAGE #6

RIGHT HAND		RIGHT HAND SHOWN					
INCLUDED ANGLE	TOOLHOLDER No.	TOOL LENGTH	SHANK DIA.	INSERT ANGLE	INSERT NO.	SCREW No.	WRENCH No.
82°	CSH-90-375R	1.5	.375	41°	CSI-41R	CTD-3126	CTD-3344
90°	CSH-90-375R	1.5	.375	45°	CSI-45R	CTD-3126	CTD-3344
100°	CSH-90-375R	1.5	.375	50°	CSI-50R	CTD-3126	CTD-3344
120°	CSH-120-375R	1.5	.375	60°	CSI-60R	CTD-3126	CTD-3344
90°	CSH-90-437R	1.5	.4375	45°	CSI-45R	CTD-3126	CTD-3344
82°	CSH-90-500R	1.5	.500	41°	CSI-41R	CTD-3126	CTD-3344
90°	CSH-90-500R	1.5	.500	45°	CSI-45R	CTD-3126	CTD-3344
100°	CSH-90-500R	1.5	.500	50°	CSI-50R	CTD-3126	CTD-3344
120°	CSH-120-500R	1.5	.500	60°	CSI-60R	CTD-3126	CTD-3344
90°	CSH-90-625R	1.5	.625	45°	CSI-45R	CTD-3126	CTD-3344
90°	CSH-90-750R	1.5	.750	45°	CSI-45R	CTD-3126	CTD-3344
90°	CSH-90-10MMR	1.5	.3937	45°	CSI-45R	CTD-3126	CTD-3344

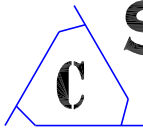

# SQUARE CUT-OFF INSERT CARBIDE & HSS

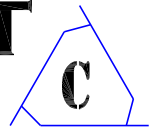

**PATENT No. D307859**

SEE HOLDERS ON PAGES #12, #13, #14, #16, #15, #17, #18, AND #19

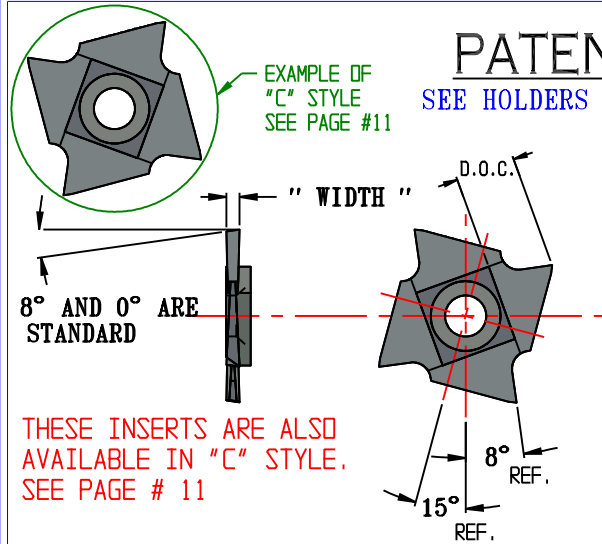

## .750 I.C. INSERTS

R.H. INSERTS	L.H. INSERTS	WIDTH	D.O.C.	MAX. DIA CUT OFF
SLPR-031	SLPL-031	.031	.109	.187
SLPR-047	SLPL-047	.047	.175	.312
SLPR-063	SLPL-063	.063	.285	.500
SLPR-078	SLPL-078	.078	.304	.562
SLPR-094	SLPL-094	.094	.304	.562
SLPR-125	SLPL-125	.125	.308	.562

INSERTS SHOWN ARE RIGHT HAND WITH 8°  
EXAMPLE: SLPR-063  
FOR 0° END ORDER AS SLPR-.063-0  
SEE PAGE #10 FOR ORDERING CONFIGURATIONS

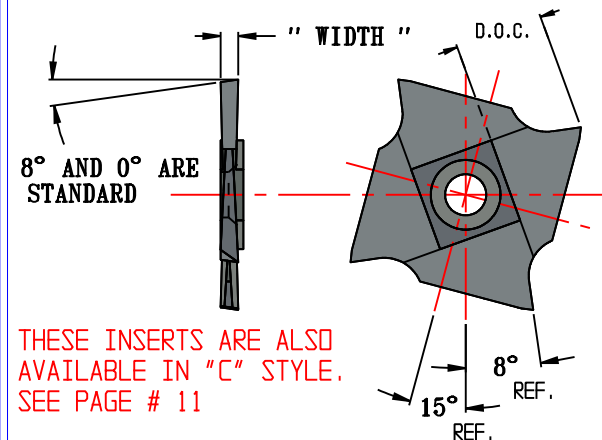

## 1.000 I.C. INSERTS

R.H. INSERTS	L.H. INSERTS	WIDTH	D.O.C.	MAX. DIA CUT OFF
ELPR-063	ELPL-063	.063	.450	.844
ELPR-078	ELPL-078	.078	.450	.844
ELPR-094	ELPL-094	.094	.450	.844
ELPR-125	ELPL-125	.125	.450	.844

INSERTS SHOWN ARE RIGHT HAND WITH 8°  
EXAMPLE: ELPR-094  
FOR 0° END ORDER AS ELPR-.094-0  
SEE PAGE #10 FOR ORDERING CONFIGURATIONS

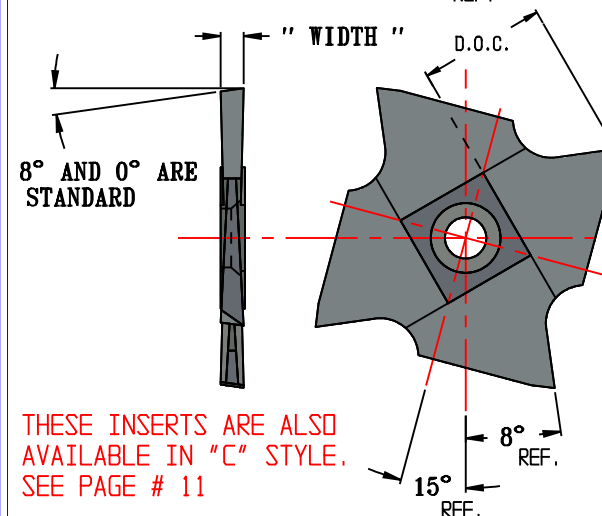

## 1.312 I.C. INSERTS

R.H. INSERTS	L.H. INSERTS	WIDTH	D.O.C.	MAX. DIA CUT OFF
HLPR-063	HLPL-063	.063	.675	1.250
HLPR-078	HLPL-078	.078	.675	1.250
HLPR-094	HLPL-094	.094	.675	1.250
HLPR-125	HLPL-125	.125	.675	1.250

INSERTS SHOWN ARE RIGHT HAND WITH 8°  
EXAMPLE: HLPR-125  
FOR 0° END ORDER AS HLPR-.125-0  
SEE PAGE #10 FOR ORDERING CONFIGURATIONS

**\*\*OTHER CONFIGURATIONS AVAILABLE BY SPECIAL ORDER\*\***

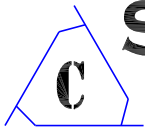

# SQUARE CUT-OFF INSERT WITH CHIP CONTROL

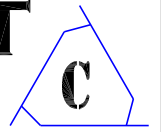

REF. PAGE 8 for D.O.C.

PATENT No. 8,734,064 B2

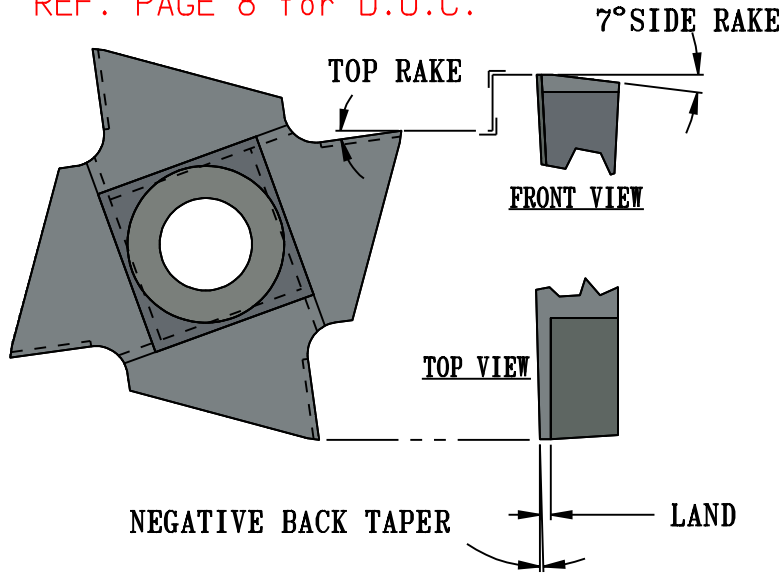

## BENEFITS

- \* GROUND CHIP CONTROL
- \* CONTROLS CHIP AWAY FROM COOLANT FLOW
- \* LONGER TOOL LIFE
- \* MINIMUM DOWN TIME
- \* CONSISTENT QUALITY

## ORDERING EXAMPLES

INSERT I.C.	R.H. INSERTS	L.H. INSERTS	WIDTH
.750 I.C.	CTD-9300R-063	CTD-9300L-063	.063
1.000 I.C.	CTD-9310R-125	CTD-9310L-125	.125
1.312 I.C.	CTD-9320R-094	CTD-9320L-094	.094

SEE HOLDERS ON PAGES #12, #13, #14, #15, #16, #17, AND #18

**CHIP CONTROL IS AVAILABLE FOR MOST CUT-OFF INSERTS  
PRICED ON REQUEST**

## PATENT No. D307859

REF. PAGE 8 for D.O.C.

## BENEFITS

- \* CHIP CONTROL
- \* GROUND IN CHIP CONTROL FOR SUPERIOR PERFORMANCE
- \* LONGER TOOL LIFE
- \* MINIMUM DOWN TIME
- \* CONSISTENT QUALITY

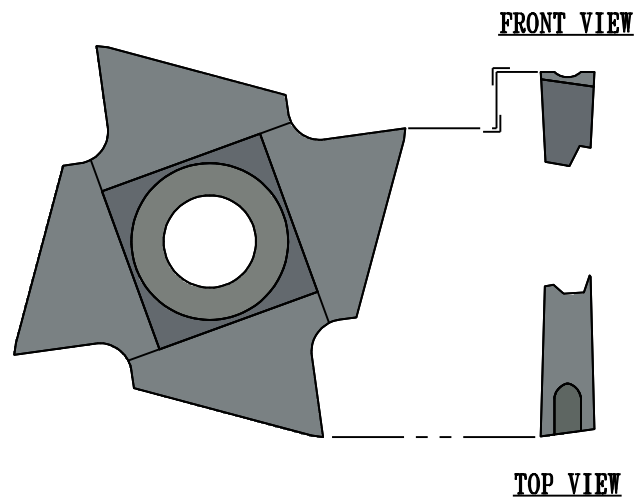

## ORDERING EXAMPLES

INSERT I.C.	R.H. INSERTS	L.H. INSERTS	WIDTH
.750 I.C.	SLCBL-063	SLCBL-063	.063
1.000 I.C.	ELCBL-125	ELCBL-125	.125
1.312 I.C.	HLCBL-094	HLCBL-094	.094

SEE HOLDERS ON PAGES #12, #13, #14, #15, #16, #17, AND #18

**CHIP CONTROL IS AVAILABLE FOR ALL CUT-OFF INSERTS  
PRICED ON REQUEST**

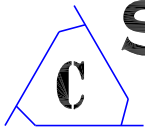

# SQUARE CUT-OFF INSERT TOOL SPECIFICATIONS

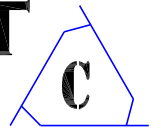

PATENT No. D307859

FOR SQUARE CUT-OFF INSERTS

8° OR 0° STANDARD

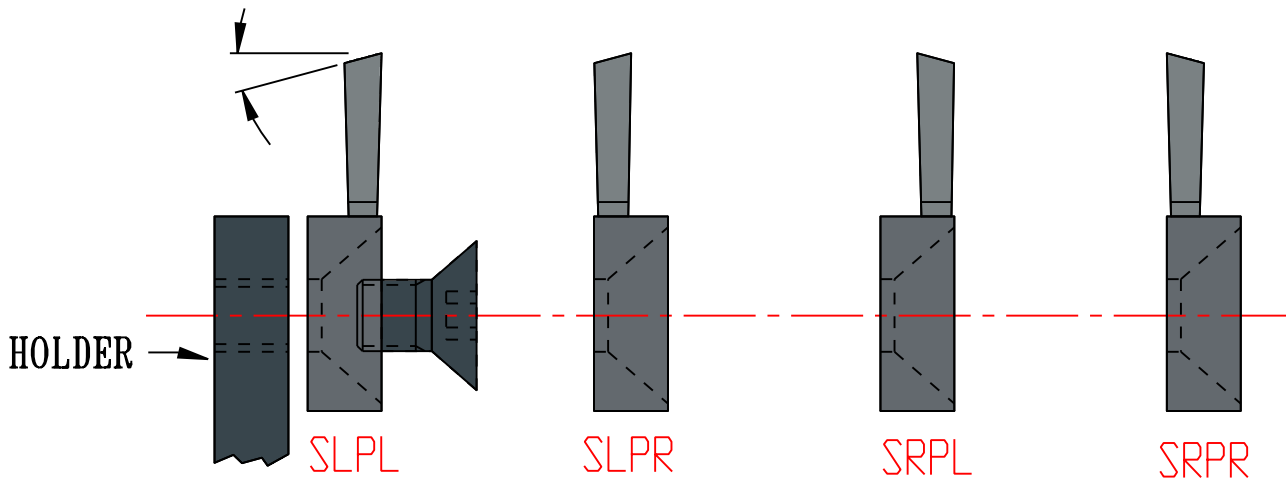

1ST LETTER DETERMINES TOOL SIZE.

S = .750 I.C., E = 1.000 I.C., H = 1.312 I.C.

2ND LETTER = CUTTING ANGLE DIRECTION FOR 8°.

3RD LETTER = POSITIVE GROUND, REPLACE THE 'P' WITH 'CB' GIVES THE INSERT A CHIP BREAKER.

4TH LETTER = TOOL HEAD LOCATION LEFT OR RIGHT

1ST 3 NUMBERS AFTER DASH (-) = CUT-OFF WIDTH

ANY NUMBERS AFTER 2ND DASH (-) = FRONT ANGLE

0 AFTER 3RD DASH (-) = 0° BACK

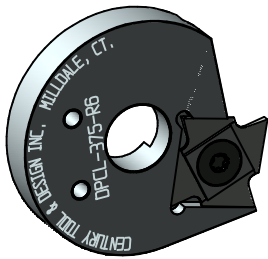

EXAMPLES;

SLPL-.063 = .750 I.C., 8° FRONT ANGLE TO LEFT, HEAD AWAY FROM HOLDER, AND .063 WIDE.

SLPR-.063-15-0 = .750 I.C., 15° FRONT ANGLE TO LEFT, HEAD .063 WIDE, CLOSE TO HOLDER AND, 0° BACK

\*OTHER CONFIGURATIONS AVAILABLE BY SPECIAL ORDER\*

**ALL OF THE ABOVE INSERTS SHOW THE  
TOP VIEW OF THE CUTTING EDGE**

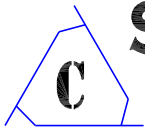

# SQUARE CUT-OFF INSERT TOOL SPECIFICATIONS

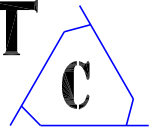

## PATENT No. D307859 FOR SQUARE CUT-OFF INSERTS

### "C" STYLE INSERTS

8° OR 0° ARE STANDARD

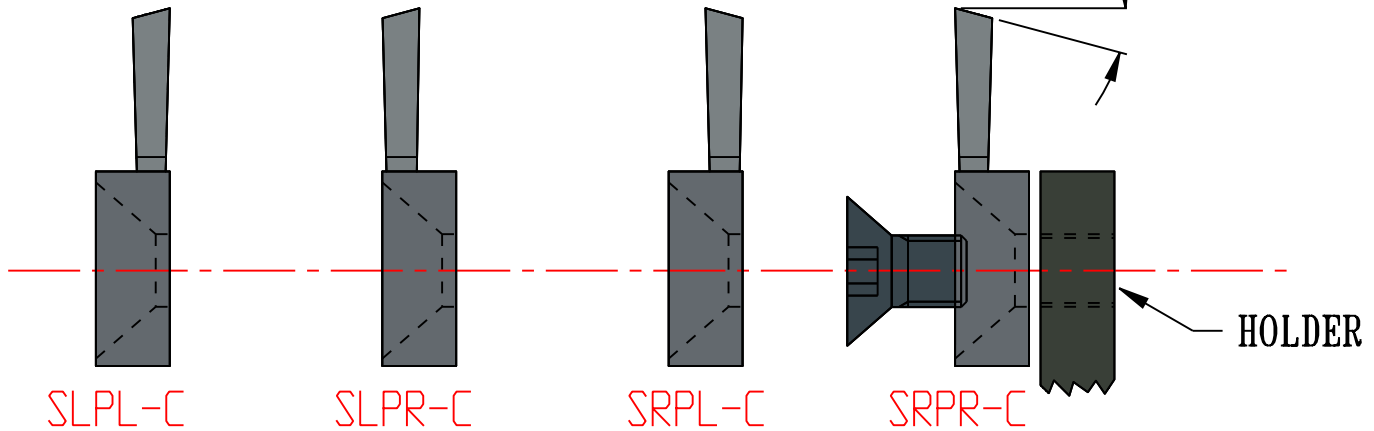

1ST LETTER DETERMINES TOOL SIZE.

S = .750 I.C., E = 1.000 I.C., H = 1.312 I.C.

2ND LETTER = CUTTING ANGLE DIRECTION FOR 8°

3RD LETTER = POSITIVE GROUND, REPLACE 'P'  
WITH 'CB' GIVES THE INSERT A CHIP BREAKER.

4TH LETTER = TOOL HEAD LOCATION LEFT OR RIGHT

1ST 3 NUMBERS AFTER DASH (-) = CUT-OFF WIDTH

C AFTER 3 NUMBERS, INSERT CUTS CLOSE TO COLLET

ANY NUMBERS AFTER 2ND DASH (-) = FRONT ANGLE

0 AFTER 3RD DASH (-) = 0° BACK

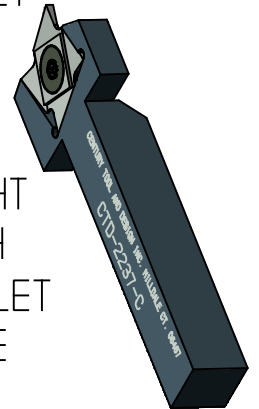
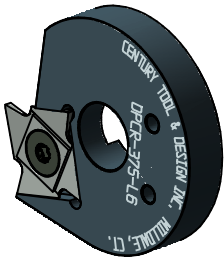

EXAMPLES;

SLPL-.063C = .750 I.C., 8° FRONT ANGLE TO LEFT,  
HEAD NEAR HOLDER AND .063 WIDE.

SLPR-.063C-15-0 = .750 I.C., 15° FRONT ANGLE TO LEFT,  
HEAD .063 WIDE, AWAY FROM HOLDER, AND 0° BACK.

\*OTHER CONFIGURATIONS AVAILABLE BY SPECIAL ORDER\*

**ALL OF THE ABOVE INSERTS SHOW THE  
TOP VIEW OF THE CUTTING EDGE**

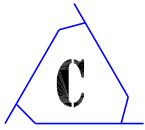

# ACME CUT-OFF TOOLHOLDERS

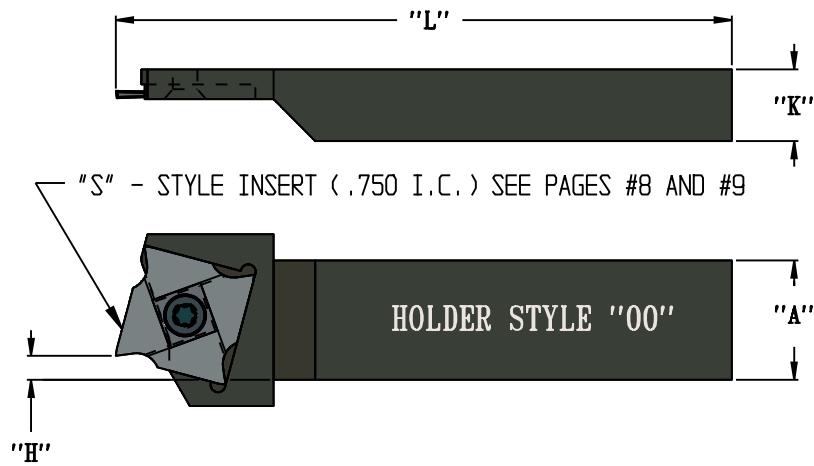
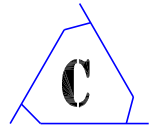

PATENT No. D307859

MACHINE	TOOLHOLDER NUMBER	HOLDER STYLE	"A"	"H"	"L"	"K"	SCREW No.	WRENCH No.
R/A 7/16	ACSR-25	00	.988	.251	6.00	1.215	CTD-3341	CTD-3619
R/A 9/16	ACSR-30	00	1.188	.251	5.00	.595	CTD-3341	CTD-3619
R/A 1-1/4	ACSR-40	BB	1.781	.453	5.00	.845	CTD-3341	CTD-3619
R/A 1-5/8	ACSR-50	BB	1.875	.485	6.00	1.235	CTD-3341	CTD-3619
R/A 2	ACSR-60	BB	2.250	.407	6.00	1.235	CTD-3341	CTD-3619
R/A 3	ACSR-80	00	2.500	.219	6.00	1.484	CTD-3341	CTD-3619

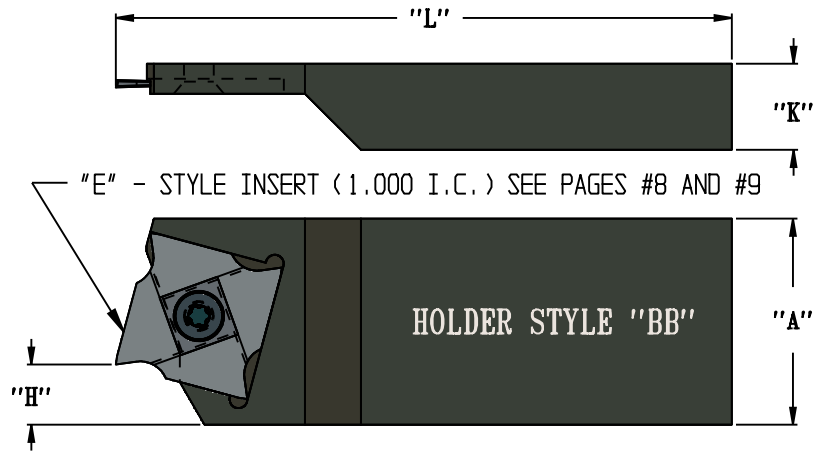

PATENT No. D307859

MACHINE	TOOLHOLDER NUMBER	HOLDER STYLE	"A"	"H"	"L"	"K"	SCREW No.	WRENCH No.
R/A 7/16	ECSR-25	00	.988	.251	6.00	1.215	CTD-4857	CTD-3619
R/A 9/16	ECSR-30	00	1.188	.251	5.00	.595	CTD-4857	CTD-3619
R/A 1-1/4	ECSR-40	BB	1.781	.453	5.00	.845	CTD-4857	CTD-3619
R/A 1-5/8	ECSR-50	BB	1.875	.485	6.00	1.235	CTD-4857	CTD-3619
R/A 2	ECSR-60	BB	2.250	.407	6.00	1.235	CTD-4857	CTD-3619
R/A 3	ECSR-80	00	2.500	.219	6.00	1.484	CTD-4857	CTD-3619

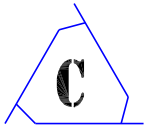

# SPECIAL ACME TOOLHOLDERS

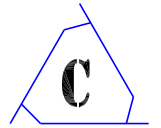

## ENGINEERED TOOLING USED ON ACME MACHINES

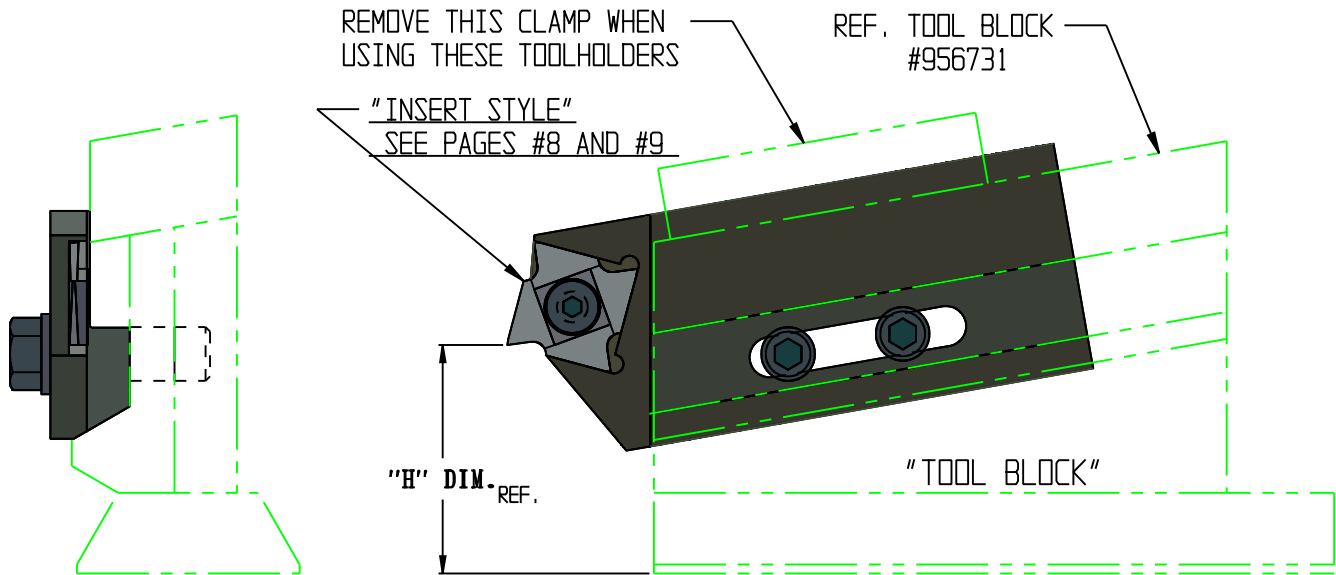

"TOOL BLOCK"	"MACHINE" SIZE	"INSERT STYLE"	"INSERT I.C."	TOOLHOLDER NUMBER	SCREW No.	WRENCH No.	"H" DIM.
956731	7/16	"S"	.750 I.C.	CTD-3092	CTD-3341	CTD-3619	1.594 REF.
956731	7/16	"E"	1.000 I.C.	CTD-3220	CTD-4857	CTD-3619	1.594 REF.
TF-976249	1-1/4	"S"	.750 I.C.	CTD-9261	CTD-3341	CTD-3619	1.560 REF.

## ENGINEERED TOOLING FOR A 7/16 ACME MACHINE - POSITION No. 2

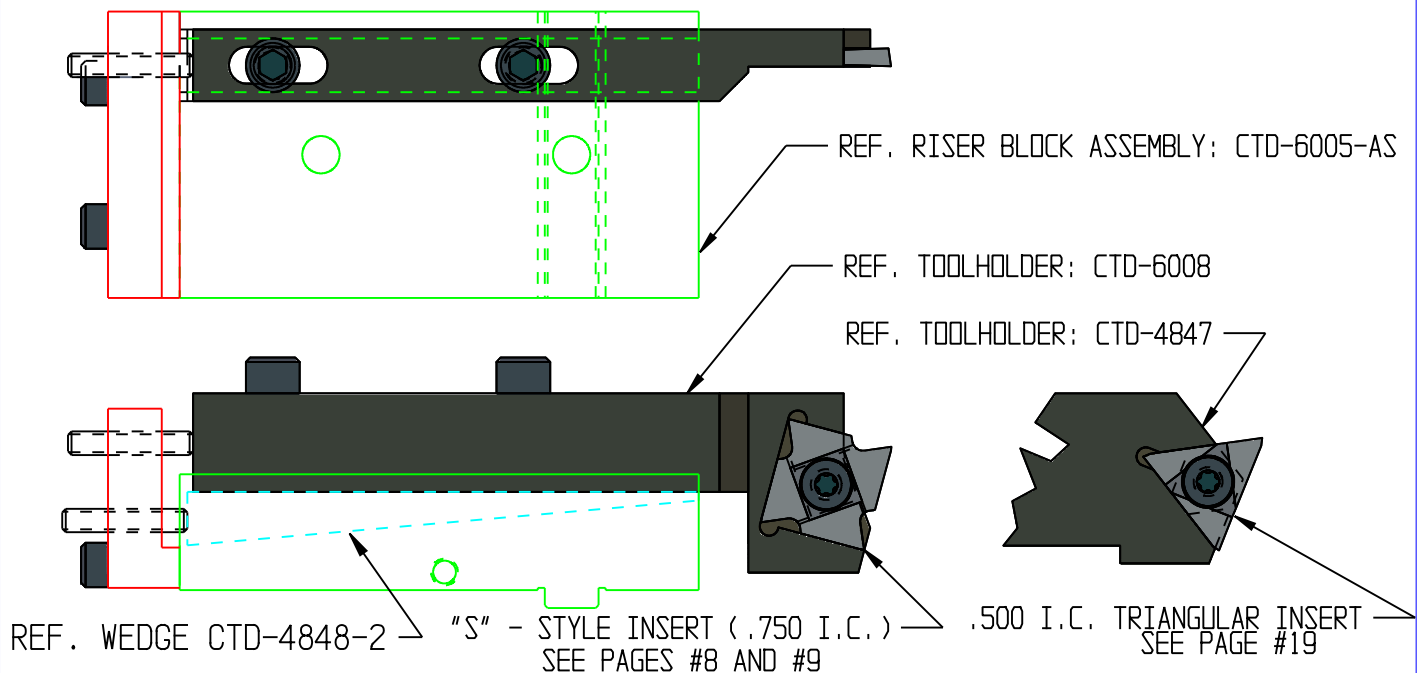



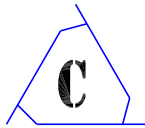

# BROWN & SHARPE TOOLHOLDERS

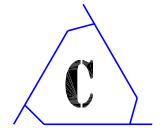

PATENT No. D307859

## BROWN & SHARPE RIGHT HAND TOOLHOLDERS

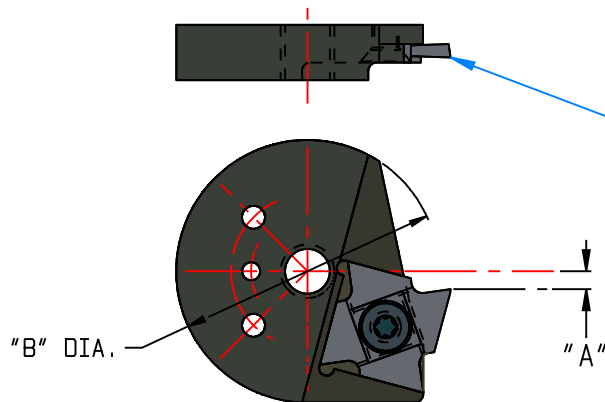

"INSERT STYLE" SEE PAGES #8 AND #9

"S" - STYLE INSERT (.750 I.C.)

"E" - STYLE INSERT (1.000 I.C.)

"H" - STYLE INSERT (1.312 I.C.)

CUTTING TOOL EDGE CONFIGURATIONS SEE PAGE #10

MACHINE	TOOLHOLDER NUMBER	INSERT STYLE	"A"	"B"	SCREW No.	WRENCH No.
#00	00BS-375R-6	"S"	.125	1.75	CTD-3341	CTD-3619
#0	0BS-375R-6	"S"	.156	2.25	CTD-3341	CTD-3619
#2	2BS-375R-6	"S"	.250	3.00	CTD-3341	CTD-3619
#2	2BS-375R-8	"E"	.250	3.00	CTD-4857	CTD-3619
#2	2BS-375R-21	"H"	.250	3.00	CTD-4857	CTD-3619

## BROWN & SHARPE LEFT HAND TOOLHOLDERS

"INSERT STYLE" SEE PAGE #8 AND #9

"S-C" - STYLE INSERT (.750 I.C.)

"E-C" - STYLE INSERT (1.000 I.C.)

"H-C" - STYLE INSERT (1.312 I.C.)

CUTTING TOOL EDGE CONFIGURATIONS SEE PAGE #11

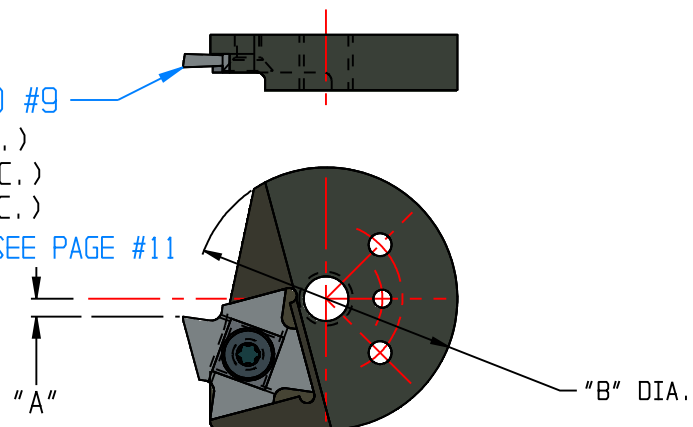

MACHINE	TOOLHOLDER NUMBER	INSERT STYLE	"A"	"B"	SCREW No.	WRENCH No.
#00	00BS-375L-6	"S-C"	.125	1.75	CTD-3341	CTD-3619
#0	0BS-375L-6	"S-C"	.156	2.25	CTD-3341	CTD-3619
#2	2BS-375L-6	"S-C"	.250	3.00	CTD-3341	CTD-3619
#2	2BS-375L-8	"E-C"	.250	3.00	CTD-4857	CTD-3619
#2	2BS-375L-21	"H-C"	.250	3.00	CTD-4857	CTD-3619

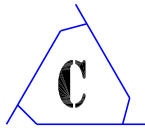

# DAVENPORT CUT-OFF TOOLHOLDERS

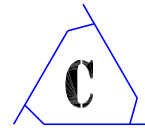

PATENT No. D307859

## DAVENPORT REGULAR C/O TOOLHOLDER

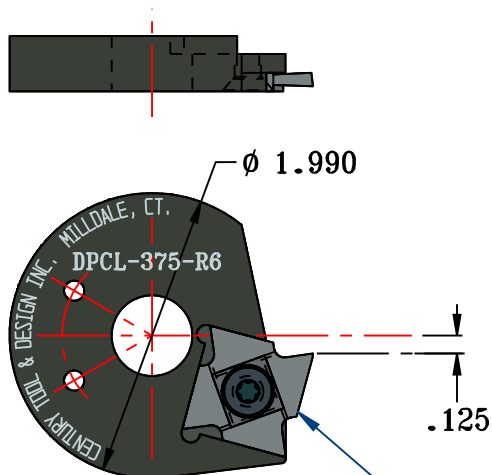

THE INSERT SHOWN IS RIGHT HAND EXAMPLE - SLPR-078

TOOLHOLDER No.	SCREW No.	WRENCH No.
DPCL-375-R6	CTD-3341	CTD-3619

"S"-STYLE INSERT (.750 I.C.)  
SEE PAGES #8 AND #9

## DAVENPORT OVERSIZE C/O TOOLHOLDER

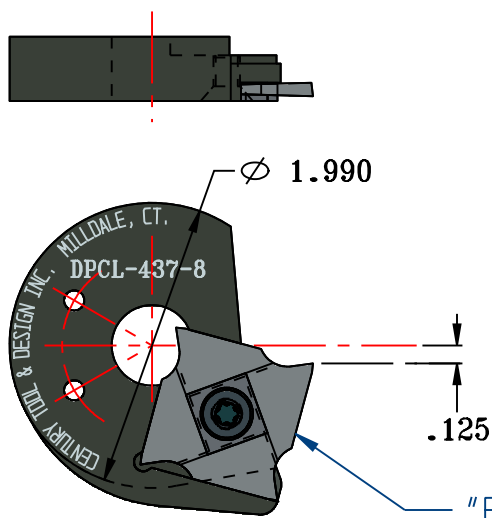

THE INSERT SHOWN IS RIGHT HAND EXAMPLE - ELPR-094

TOOLHOLDER No.	SCREW No.	WRENCH No.
DPCL-437-8	CTD-4857	CTD-3619

"E"-STYLE INSERT (1.000 I.C.)  
SEE PAGES #8 AND #9

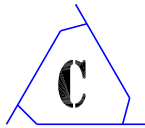

# NEW BRITAIN CUT-OFF TOOLHOLDERS

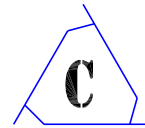

PATENT No. D307859

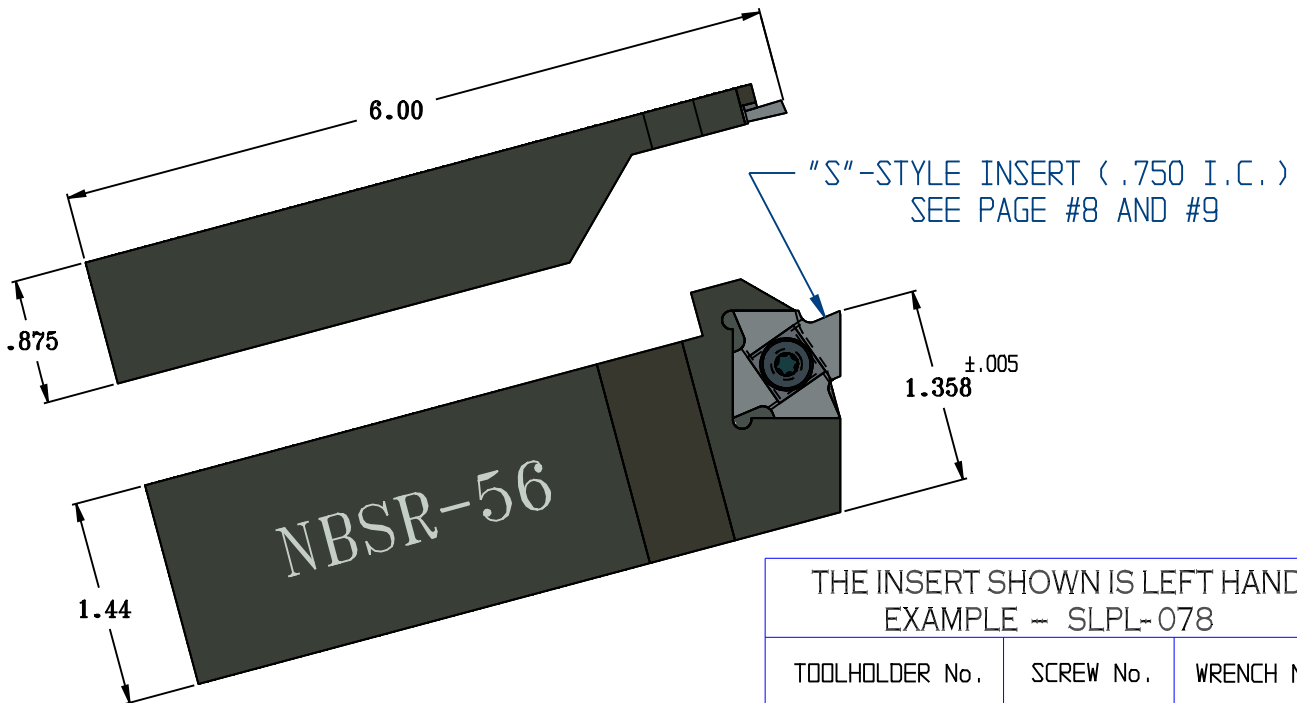

THE INSERT SHOWN IS LEFT HAND  
EXAMPLE -- SLPL-078

TOOLHOLDER No.	SCREW No.	WRENCH No.
NBSR-56	CTD-3341	CTD-3619

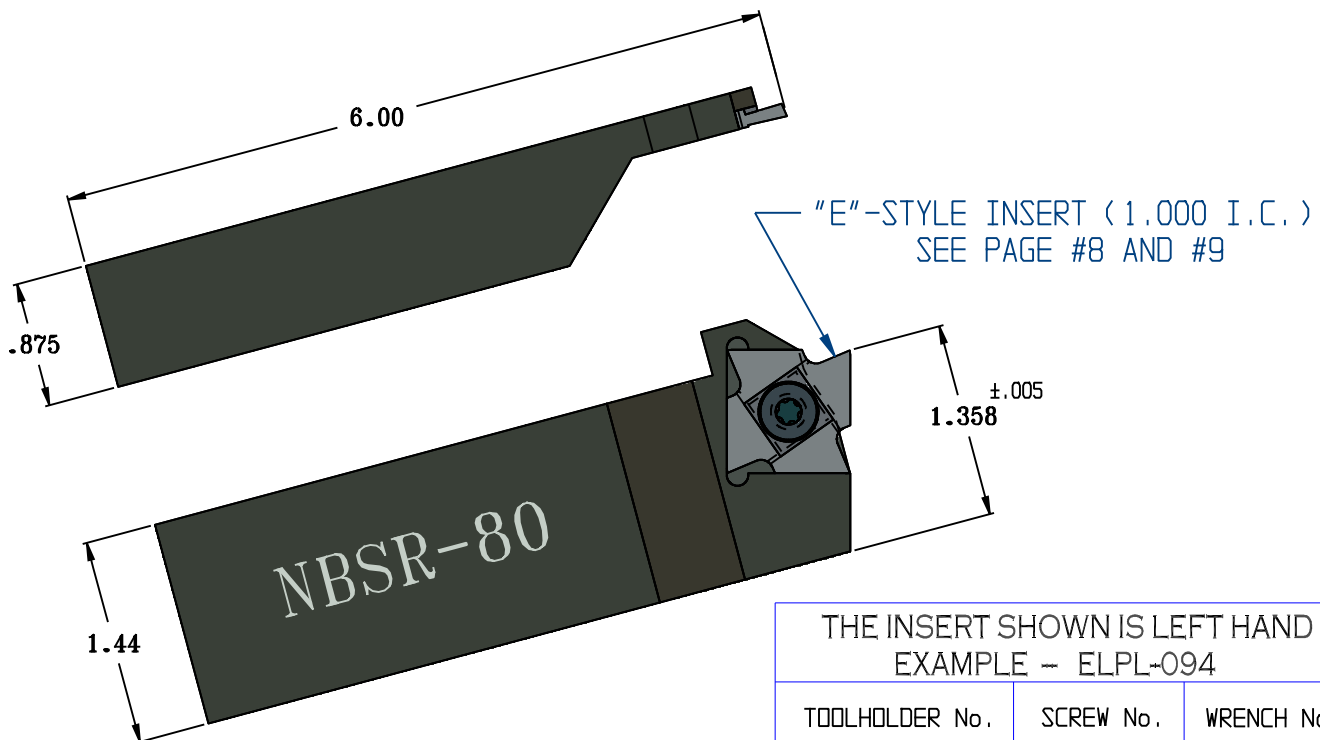

THE INSERT SHOWN IS LEFT HAND  
EXAMPLE -- ELPL-094

TOOLHOLDER No.	SCREW No.	WRENCH No.
NBSR-80	CTD-4857	CTD-3619

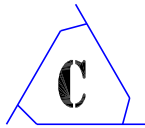

# CNC & SWISS TYPE TOOLHOLDERS

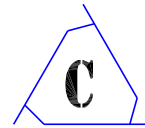

PATENT No. D307859

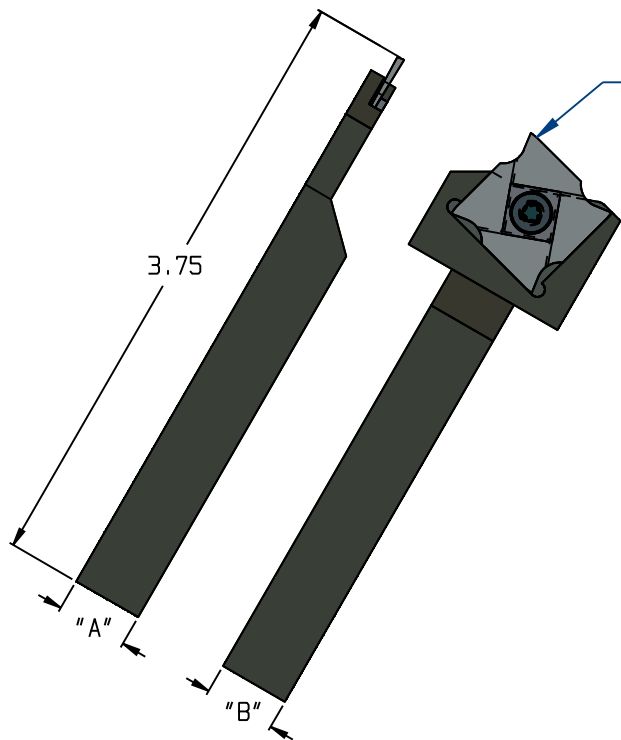

"S" - STYLE INSERT (.750 I.C.)  
SEE PAGES #8 AND #9

INSERTS SHOWN ARE RIGHT HAND  
EXAMPLE: SLPR-063

TOOLHOLDER No.	"A"	"B"	SCREW No.	WRENCH No.
CTD-2117	.312	.312	CTD-3341	CTD-3619
CTD-2333	.375	.375	CTD-3341	CTD-3619
CTD-2237	.500	.500	CTD-3341	CTD-3619
CTD-1099	.500	.625	CTD-3341	CTD-3619
CTD-2218	.750	.750	CTD-3341	CTD-3619
CTD-2220	.750	1.000	CTD-3341	CTD-3619
CTD-4005	8 MM	8 MM	CTD-3341	CTD-3619
CTD-4006	10 MM	10 MM	CTD-3341	CTD-3619
CTD-4007	12 MM	12 MM	CTD-3341	CTD-3619

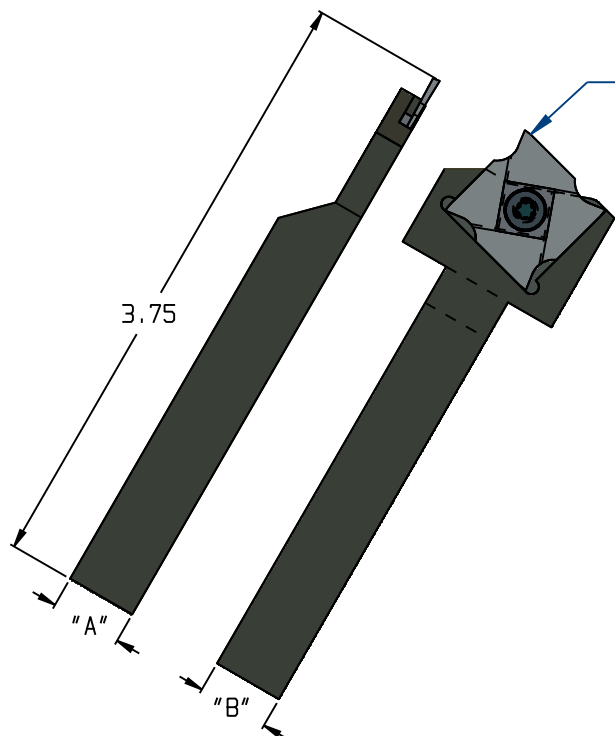

"S" - STYLE INSERT (.750 I.C.)  
SEE PAGES #8 AND #9

INSERTS SHOWN ARE LEFT HAND  
EXAMPLE: SLPL-063

TOOLHOLDER No.	"A"	"B"	SCREW No.	WRENCH No.
CTD-4272	.375	.375	CTD-3341	CTD-3619
CTD-3175	.500	.500	CTD-3341	CTD-3619
CTD-4276	.625	.625	CTD-3341	CTD-3619
CTD-8183	.750	.750	CTD-3341	CTD-3619
CTD-4271	8 MM	8 MM	CTD-3341	CTD-3619
CTD-4273	10 MM	10 MM	CTD-3341	CTD-3619
CTD-4274	12 MM	12 MM	CTD-3341	CTD-3619

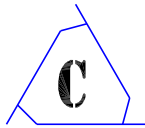

# CNC & SWISS TYPE TOOLHOLDERS

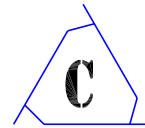

## PATENT No. D307859

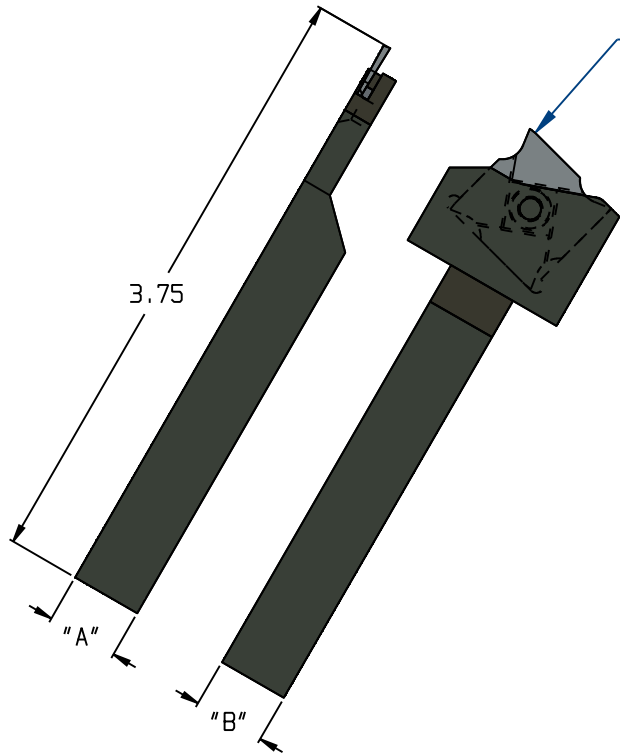

"S"-C - STYLE INSERT (.750 I.C.)  
SEE PAGES #8 AND #9

INSERTS SHOWN ARE RIGHT HAND  
EXAMPLE: SLPR-063C

TOOLHOLDER No.	"A"	"B"	SCREW No.	WRENCH No.
CTD-2117C	.312	.312	CTD-3341	CTD-3619
CTD-2333C	.375	.375	CTD-3341	CTD-3619
CTD-2237C	.500	.500	CTD-3341	CTD-3619
CTD-1099C	.500	.625	CTD-3341	CTD-3619
CTD-2218C	.750	.750	CTD-3341	CTD-3619
CTD-2220C	.750	1.000	CTD-3341	CTD-3619
CTD-4005C	8 MM	8 MM	CTD-3341	CTD-3619
CTD-4006C	10 MM	10 MM	CTD-3341	CTD-3619
CTD-4007C	12 MM	12 MM	CTD-3341	CTD-3619

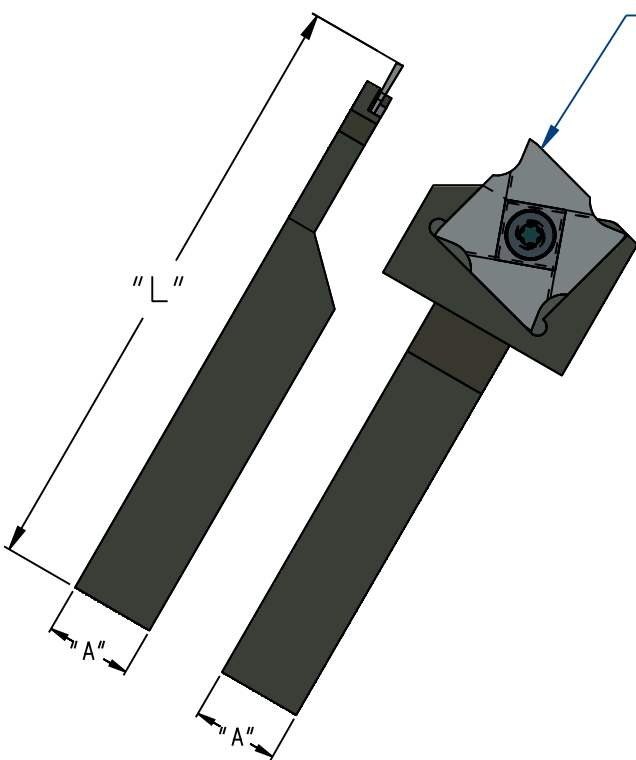

"E" - STYLE INSERT (1.000 I.C.)  
"H" - STYLE INSERT (1.312 I.C.)  
SEE PAGE #8 AND #9

INSERTS SHOWN ARE RIGHT HAND  
EXAMPLE: - ELPR-063

TOOLHOLDER No.	"A"	"L"	SCREW No.	WRENCH No.
CTD-4784	.500	4.0	CTD-4857	CTD-3619
CTD-4785	.625	6.0	CTD-4857	CTD-3619
CTD-4786	.750	6.0	CTD-4857	CTD-3619
CTD-4656	1.000	6.0	CTD-4857	CTD-3619
CTD-4783	12 MM	100 MM	CTD-4857	CTD-3619
CTD-4105	16 MM	150 MM	CTD-4857	CTD-3619
CTD-4106	20 MM	150 MM	CTD-4857	CTD-3619

INSERT SHOWN IS RIGHT HAND  
EXAMPLE: - HLP-094

TOOLHOLDER No.	"A"	"L"	SCREW No.	WRENCH No.
CTD-8178	.750	6.0	CTD-4857	CTD-3619

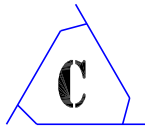

# CARBIDE TRIANGULAR CUT OFF INSERTS

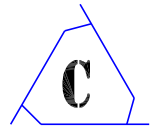

PATENT No. 8,734,064 B2

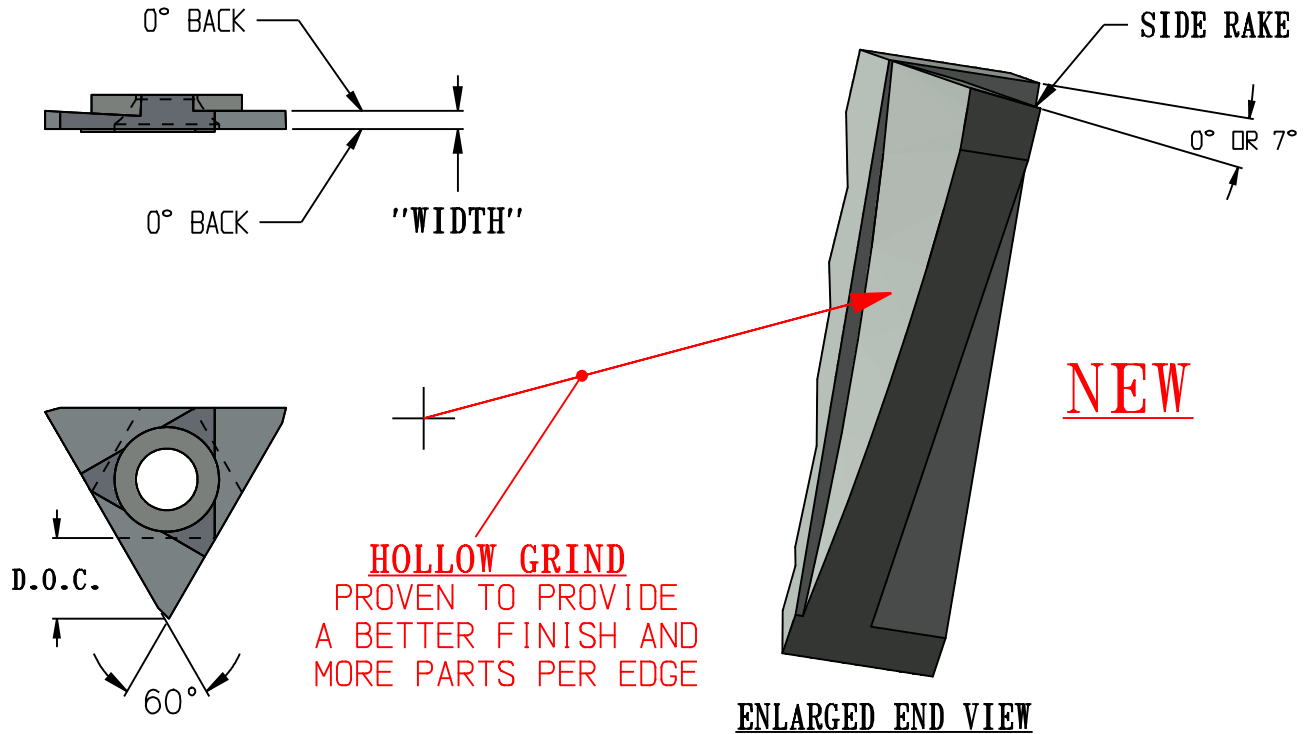

## .500 I.C. INSERTS

0° SIDE RAKE INSERT	7° SIDE RAKE INSERT	"WIDTH"	D.O.C.	MAX. DIA CUT OFF
TLPL-031	CTD-9405-031L	.031	.150	.250
TLPL-047	CTD-9405-047L	.047	.281	.470
TLPL-063	CTD-9405-063L	.063	.281	.470
TLPL-078	CTD-9405-078L	.078	.281	.470
TLPL-094	CTD-9405-094L	.094	.281	.470
TLPL-125	CTD-9405-125L	.125	.281	.470

## .625 I.C. INSERTS

0° SIDE RAKE INSERT	7° SIDE RAKE INSERT	"WIDTH"	D.O.C.	MAX. DIA CUT OFF
TIPL-063	CTD-9605-063L	.063	.345	.625
TIPL-078	CTD-9605-078L	.078	.345	.625
TIPL-094	CTD-9605-094L	.094	.345	.625
TIPL-125	CTD-9605-125L	.125	.345	.625

FOR TRIANGULAR INSERTED TOOLHOLDER INFORMATION, REFER TO PAGE 20 FOR DAVENPORT TOOLHOLDERS, AND PAGES 21 & 22 FOR THE CNC & SWISS TYPE TOOLHOLDERS.

# TRIANGULAR INSERTED DAVENPORT CUT-OFF TOOLHOLDERS

## DAVENPORT REGULAR C/O TOOLHOLDER

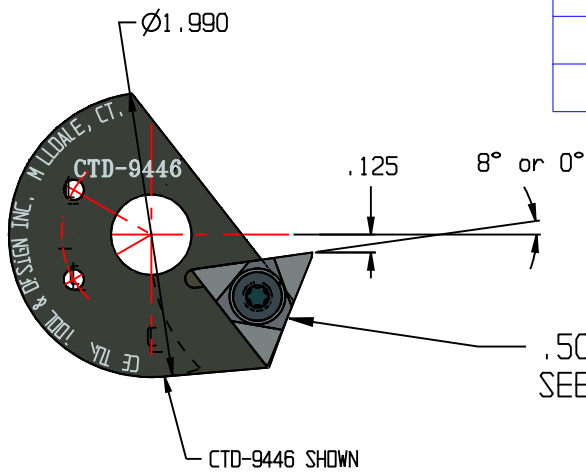

TOOLHOLDER No.	SCREW No.	WRENCH No.
CTD-9446	CTD-4857	CTD-3619
CTD-9446-0	CTD-4857	CTD-3619

ALTERNATE HEX SCREW AND WRENCH  
ORDER AS CTD-9492 FOR SCREW AND  
1/8 HEX FOR WRENCH

.500 I.C. TRIANGULAR INSERT  
SEE PAGE #19 FOR INSERT INFORMATION

## DAVENPORT OVERSIZE C/O TOOLHOLDER

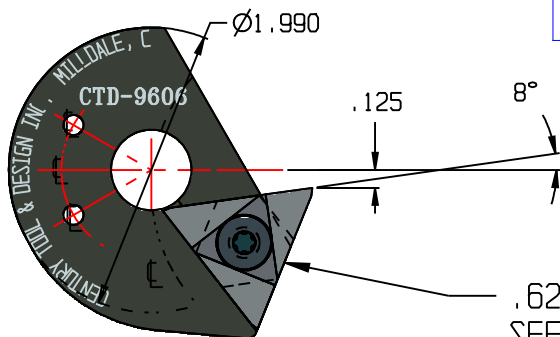

TOOLHOLDER No.	SCREW No.	WRENCH No.
CTD-9606	CTD-4857	CTD-3619

ALTERNATE HEX SCREW AND WRENCH  
ORDER AS CTD-9492 FOR SCREW AND  
1/8 HEX FOR WRENCH

.625 I.C. TRIANGULAR INSERT  
SEE PAGE #19 FOR INSERT INFORMATION

# TRIANGULAR INSERTED CNC & SWISS TYPE TOOLHOLDERS

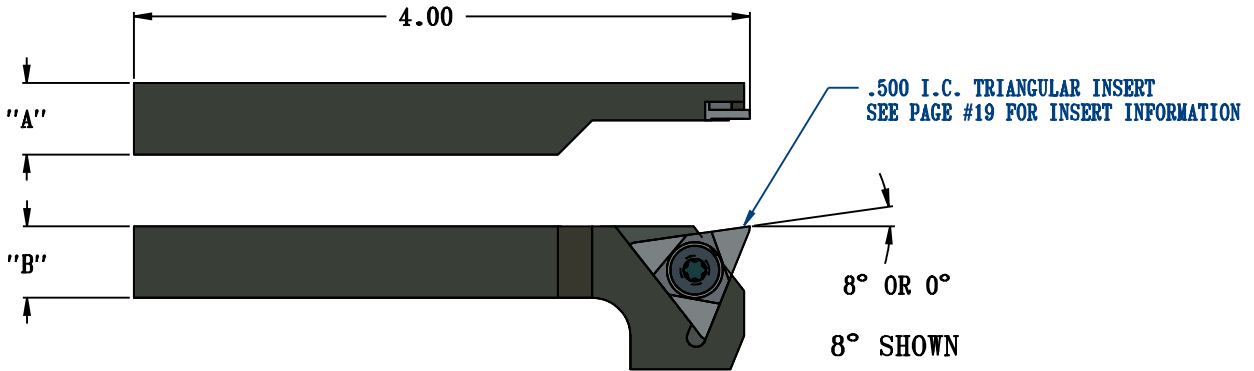
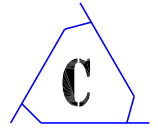
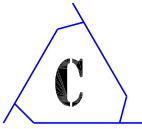

0° TOP RAKE TOOLHOLDERS	8° TOP RAKE TOOLHOLDERS	"A"	"B"	SCREW No.	WRENCH No.
CTD-9610-3	CTD-9611-3	.375	.375	CTD-4857	CTD-3619
CTD-9610-4	CTD-9611-4	.500	.500		
CTD-9610-5	CTD-9611-5	.625	.625		
CTD-9610-6	CTD-9611-6	.750	.750		
CTD-9610-8mm	CTD-9611-8mm	.315	.315		
CTD-9610-10mm	CTD-9611-10mm	.394	.394		
CTD-9610-12mm	CTD-9611-12mm	.472	.472		

ALTERNATE HEX  
SCREW AND WRENCH  
ORDER AS CTD-9492  
FOR SCREW AND 1/8  
HEX FOR WRENCH

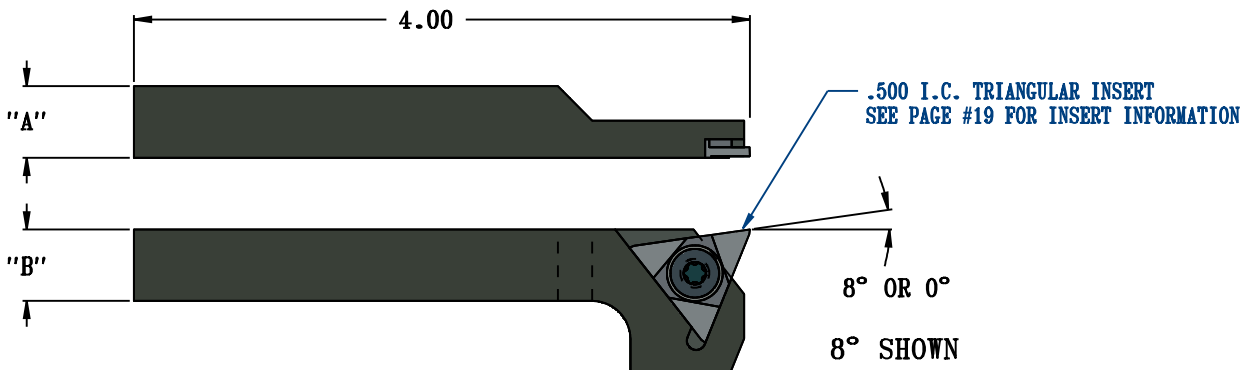

0° TOP RAKE TOOLHOLDERS	8° TOP RAKE TOOLHOLDERS	"A"	"B"	SCREW No.	WRENCH No.
CTD-9630-3	CTD-9631-3	.375	.375	CTD-4857	CTD-3619
CTD-9630-4	CTD-9631-4	.500	.500		
CTD-9630-5	CTD-9631-5	.625	.625		
CTD-9630-6	CTD-9631-6	.750	.750		
CTD-9630-8mm	CTD-9631-8mm	.315	.315		
CTD-9630-10mm	CTD-9631-10mm	.394	.394		
CTD-9630-12mm	CTD-9631-12mm	.472	.472		

ALTERNATE HEX  
SCREW AND WRENCH  
ORDER AS CTD-9492  
FOR SCREW AND 1/8  
HEX FOR WRENCH



# TRIANGULAR INSERTED CNC & SWISS TYPE TOOLHOLDERS

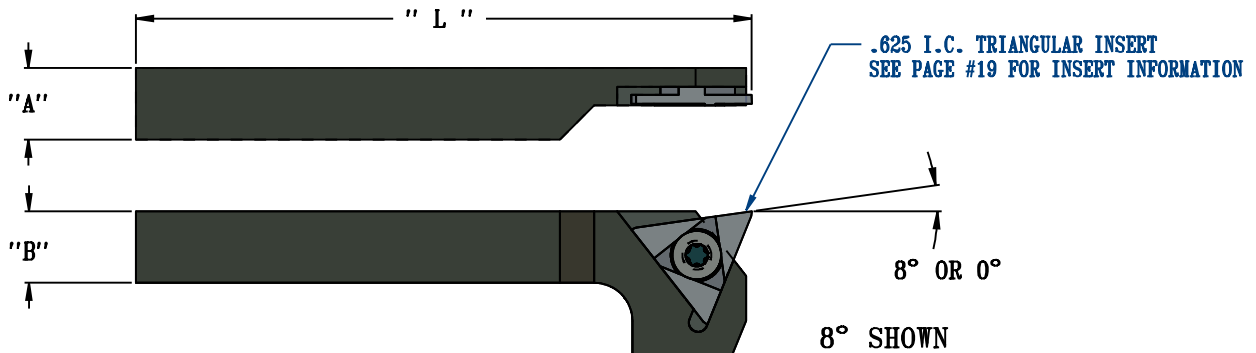
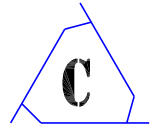
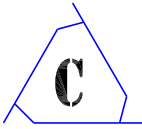

0° TOP RAKE TOOLHOLDERS	8° TOP RAKE TOOLHOLDERS	"A"	"B"	"L"	SCREW NUMBER	WRENCH NUMBER
CTD-9620-4	CTD-9621-4	.500	.500	5.00	CTD-4857	CTD-3619
CTD-9620-5	CTD-9621-5	.625	.625	6.00		
CTD-9620-6	CTD-9621-6	.750	.750	6.00		
CTD-9620-8	CTD-9621-8	1.000	1.000	6.00		
CTD-9620-12mm	CTD-9621-12mm	.472	.472	100mm		
CTD-9620-16mm	CTD-9621-16mm	.630	.630	150mm		
CTD-9620-20mm	CTD-9621-20mm	.787	.787	150mm		

ALTERNATE HEX  
SCREW AND WRENCH  
ORDER AS CTD-9492  
FOR SCREW AND 1/8  
HEX FOR WRENCH

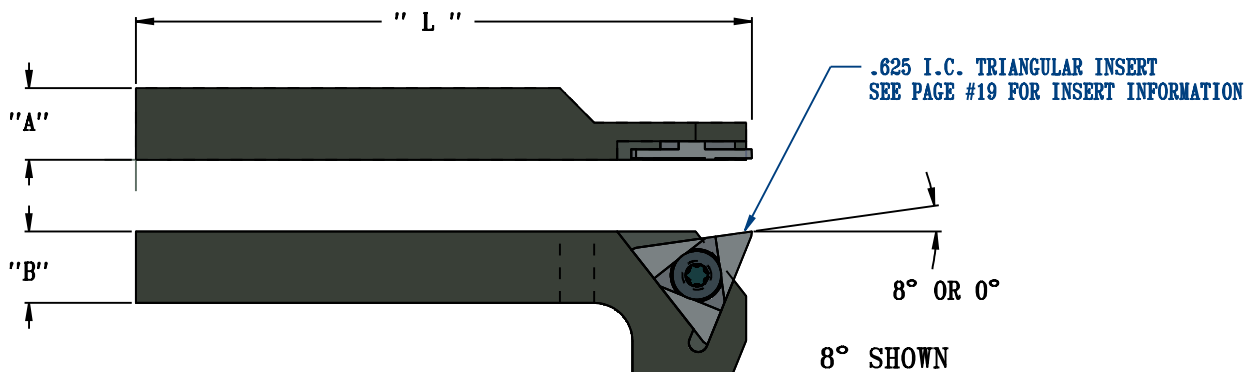

0° TOP RAKE TOOLHOLDERS	8° TOP RAKE TOOLHOLDERS	"A"	"B"	"L"	SCREW NUMBER	WRENCH NUMBER
CTD-9640-4	CTD-9641-4	.500	.500	5.00	CTD-4857	CTD-3619
CTD-9640-5	CTD-9641-5	.625	.625	6.00		
CTD-9640-6	CTD-9641-6	.750	.750	6.00		
CTD-9640-8	CTD-9641-8	1.000	1.000	6.00		
CTD-9640-12mm	CTD-9641-12mm	.472	.472	100mm		
CTD-9640-16mm	CTD-9641-16mm	.630	.630	150mm		
CTD-9640-20mm	CTD-9641-20mm	.787	.787	150mm		

ALTERNATE HEX  
SCREW AND WRENCH  
ORDER AS CTD-9492  
FOR SCREW AND 1/8  
HEX FOR WRENCH

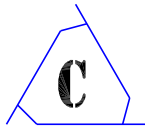

# STICK TOOL INSERTS

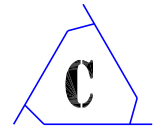

## FRONT TURN - BACK TURN - PLUNGE & TURN INSERTS

SFTR INSERTS

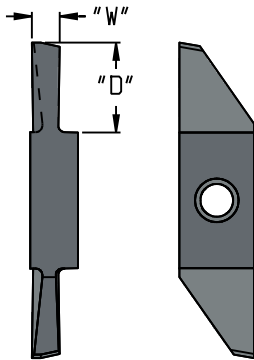

FRONT TURN			
R.H. INSERTS	L.H. INSERTS	"W"	"D"
SFTR-031	SFTL-031	.031	.093
SFTR-047	SFTL-047	.047	.125
SFTR-063	SFTL-063	.063	.250
SFTR-078	SFTL-078	.078	.275
SFTR-094	SFTL-094	.094	.300
SFTR-125	SFTL-125	.125	.320

SFTL INSERTS

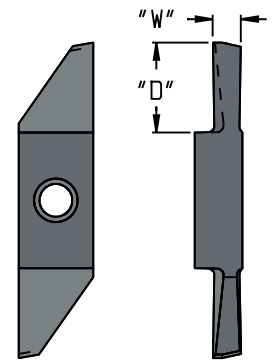

SEE PAGES "LEFT AND RIGHT HAND TURNING" FOR EXAMPLES OF USES AND FEED DIRECTION FOR INSERTS ON THIS PAGE

CBTR INSERTS

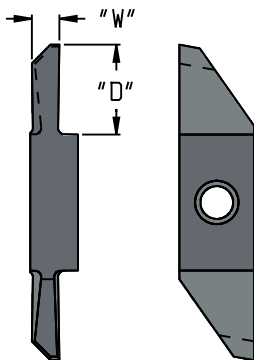

BACK TURN			
R.H. INSERTS	L.H. INSERTS	"W"	"D"
CBTR-031	CBTL-031	.031	.093
CBTR-047	CBTL-047	.047	.125
CBTR-063	CBTL-063	.063	.250
CBTR-078	CBTL-078	.078	.275
CBTR-094	CBTL-094	.094	.300
CBTR-125	CBTL-125	.125	.320

CBTL INSERTS

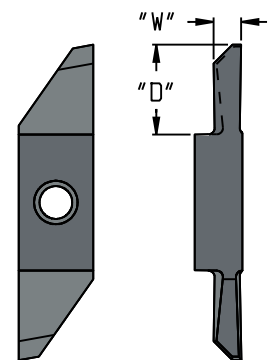

CWPR INSERTS

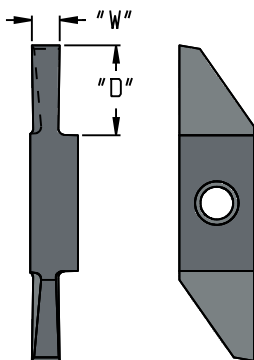

PLUNGE & TURN			
R.H. INSERTS	L.H. INSERTS	"W"	"D"
CWPR-031	CWPL-031	.031	.093
CWPR-047	CWPL-047	.047	.125
CWPR-063	CWPL-063	.063	.250
CWPR-078	CWPL-078	.078	.275
CWPR-094	CWPL-094	.094	.300
CWPR-125	CWPL-125	.125	.320

CWPL INSERTS

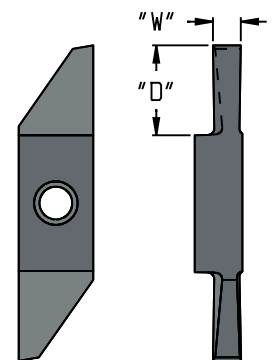

USE SWAL OR SWAR HOLDERS ON PAGE 26

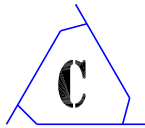

# STICK TOOL INSERTS

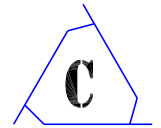

## FRONT TURN - BACK TURN - PLUNGE & TURN INSERTS

WFTL INSERTS

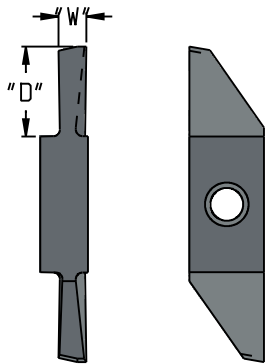

FRONT TURN			
L.H. INSERTS	R.H. INSERTS	"W"	"D"
WFTL-031	WFTR-031	.031	.093
WFTL-047	WFTR-047	.047	.125
WFTL-063	WFTR-063	.063	.250
WFTL-078	WFTR-078	.078	.275
WFTL-094	WFTR-094	.094	.300
WFTL-125	WFTR-125	.125	.320

WFTR INSERTS

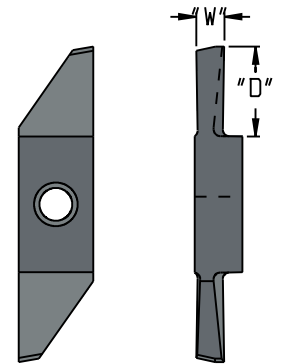

SEE PAGES **"LEFT AND RIGHT HAND TURNING"** FOR EXAMPLES OF USES AND FEED DIRECTION FOR INSERTS ON THIS PAGE

WBTL INSERTS

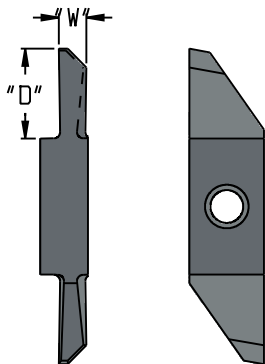

BACK TURN			
L.H. INSERTS	R.H. INSERTS	"W"	"D"
WBTL-031	WBTR-031	.031	.093
WBTL-047	WBTR-047	.047	.125
WBTL-063	WBTR-063	.063	.250
WBTL-078	WBTR-078	.078	.275
WBTL-094	WBTR-094	.094	.300
WBTL-125	WBTR-125	.125	.320

WBTR INSERTS

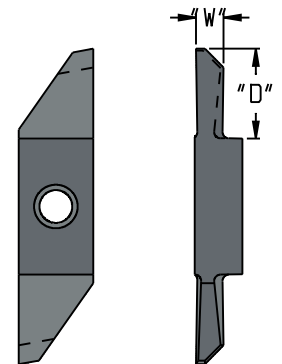

SWPL INSERTS

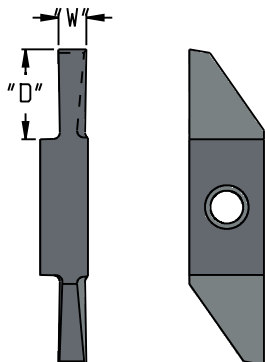

PLUNGE & TURN			
L.H. INSERTS	R.H. INSERTS	"W"	"D"
SWPL-031	SWPR-031	.031	.093
SWPL-047	SWPR-047	.047	.125
SWPL-063	SWPR-063	.063	.250
SWPL-078	SWPR-078	.078	.275
SWPL-094	SWPR-094	.094	.300
SWPL-125	SWPR-125	.125	.320

SWPR INSERTS

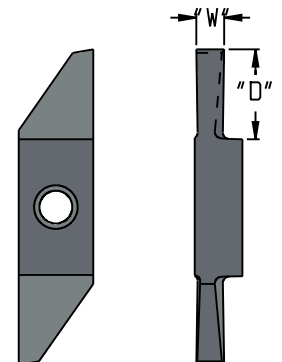

USE SWAL OR SWAR HOLDERS ON PAGE 26

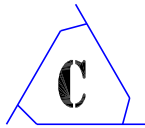

# STICK TOOL INSERTS

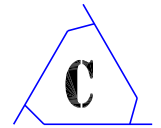

## THREADING - GROOVING - CUT - OFF INSERTS

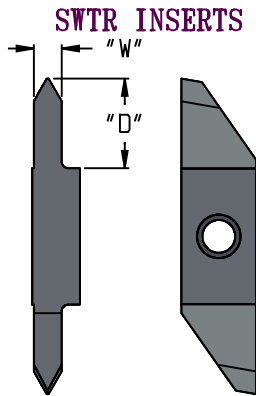

THREADING			
R.H. INSERTS	L.H. INSERTS	"W"	"D"
SWTR-031	SWTL-031	.031	.093
SWTR-047	SWTL-047	.047	.125
SWTR-063	SWTL-063	.063	.250
SWTR-078	SWTL-078	.078	.275
SWTR-094	SWTL-094	.094	.300
SWTR-125	SWTL-125	.125	.320

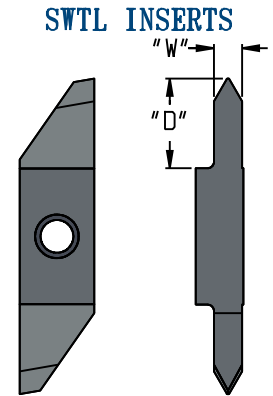

SEE PAGES "LEFT AND RIGHT HAND TURNING" FOR EXAMPLES OF USES AND FEED DIRECTION FOR INSERTS ON THIS PAGE

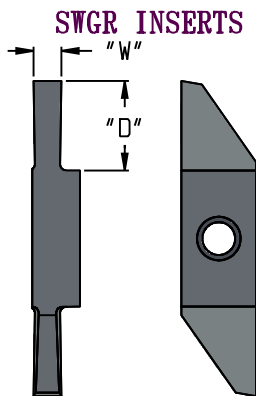

GROOVING			
R.H. INSERTS	L.H. INSERTS	"W"	"D"
SWGR-031	SWGL-031	.031	.093
SWGR-047	SWGL-047	.047	.125
SWGR-063	SWGL-063	.063	.250
SWGR-078	SWGL-078	.078	.275
SWGR-094	SWGL-094	.094	.300
SWGR-125	SWGL-125	.125	.320

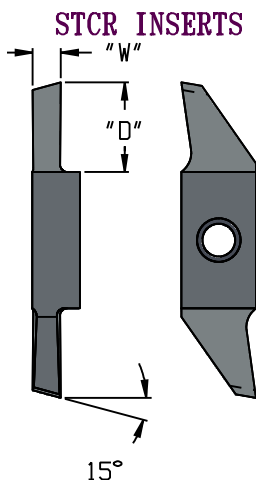
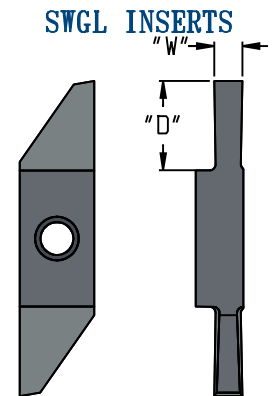

CUT - OFF			
R.H. INSERTS	L.H. INSERTS	"W"	"D"
STCR-031	STCL-031	.031	.093
STCR-047	STCL-047	.047	.125
STCR-063	STCL-063	.063	.250
STCR-078	STCL-078	.078	.275
STCR-094	STCL-094	.094	.300
STCR-125	STCL-125	.125	.320

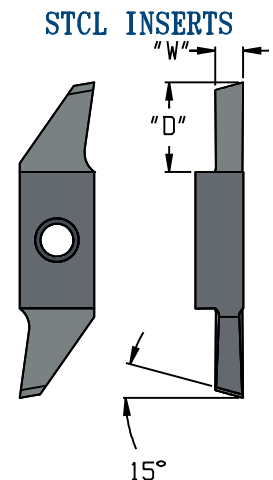

USE SWAL OR SWAR HOLDERS ON PAGE 26

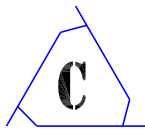

# STICK TOOL INSERTS

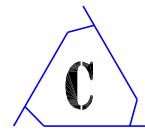

## THREADING - GROOVING - CUT - OFF INSERTS

SWTL INSERTS

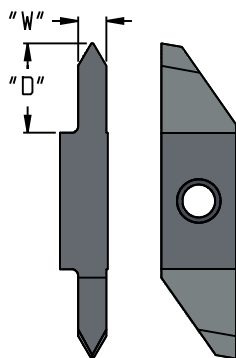

### THREADING

L.H. INSERTS	R.H. INSERTS	"W"	"D"
SWTL-031	SWTR-031	.031	.093
SWTL-047	SWTR-047	.047	.125
SWTL-063	SWTR-063	.063	.250
SWTL-078	SWTR-078	.078	.275
SWTL-094	SWTR-094	.094	.300
SWTL-125	SWTR-125	.125	.320

SWTR INSERTS

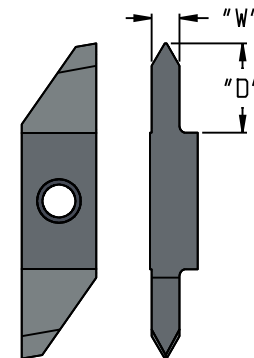

SEE PAGES **"LEFT AND RIGHT HAND TURNING"** FOR EXAMPLES OF USES AND FEED DIRECTION FOR INSERTS ON THIS PAGE

SWGL INSERTS

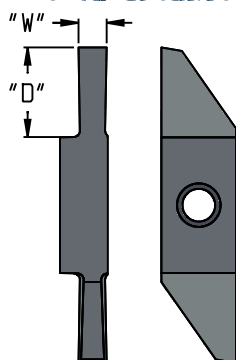

### GROOVING

L.H. INSERTS	R.H. INSERTS	"W"	"D"
SWGL-031	SWGR-031	.031	.093
SWGL-047	SWGR-047	.047	.125
SWGL-063	SWGR-063	.063	.250
SWGL-078	SWGR-078	.078	.275
SWGL-094	SWGR-094	.094	.300
SWGL-125	SWGR-125	.125	.320

SWGR INSERTS

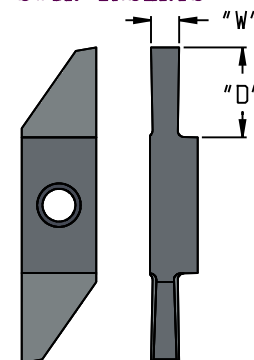

SWCL INSERTS

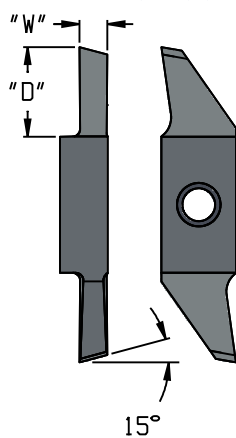

### CUT - OFF

L.H. INSERTS	R.H. INSERTS	"W"	"D"
SWCL-031	SWCR-031	.031	.093
SWCL-047	SWCR-047	.047	.125
SWCL-063	SWCR-063	.063	.250
SWCL-078	SWCR-078	.078	.275
SWCL-094	SWCR-094	.094	.300
SWCL-125	SWCR-125	.125	.320

SWCR INSERTS

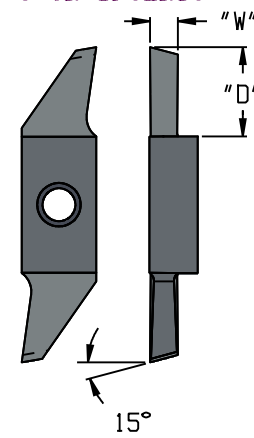

USE SWAL OR SWAR HOLDERS ON PAGE 26

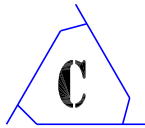

# STICK TOOL INSERTS

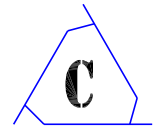

## HOLLOW GROUND STICK TOOL CUT - OFF INSERTS

PATENT No. 8,734,064 B2

TESTED & PROVEN TO BE LONGER LASTING AND PROVIDE A SUPERIOR FINISH

### SNGI-STYLE CUT - OFF INSERTS

L.H. INSERTS	R.H. INSERTS	"W"	"D"
SNGI-031-L	SNGI-031-R	.031	.093
SNGI-047-L	SNGI-047-R	.047	.125
SNGI-063-L	SNGI-063-R	.063	.250
SNGI-078-L	SNGI-078-R	.078	.275
SNGI-094-L	SNGI-094-R	.094	.300
SNGI-125-L	SNGI-125-R	.125	.320

THE ABOVE INSERTS ARE USED IN SWAL/SWAR-STYLE TOOLHOLDERS ON PAGE 26

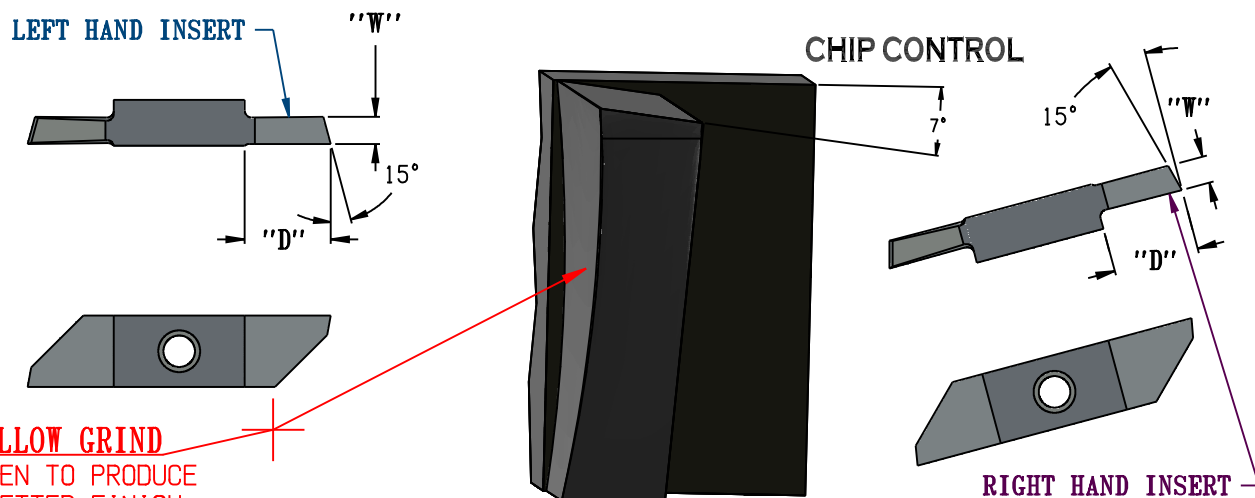

**HOLLOW GRIND**  
PROVEN TO PRODUCE  
A BETTER FINISH  
AND MORE PARTS  
PER EDGE

### ONGI-STYLE CUT - OFF INSERTS

L.H. INSERTS	R.H. INSERTS	"W"	"D"
ONGI-063-L	ONGI-063-R	.063	.400
ONGI-078-L	ONGI-078-R	.078	.400
ONGI-094-L	ONGI-094-R	.094	.400
ONGI-125-L	ONGI-125-R	.125	.400

ONGI INSERTS  
HAVE A DEEPER  
DEPTH OF CUT

THE ABOVE INSERTS ARE USED IN NGHL/NGHR-STYLE TOOLHOLDERS ON PAGE 26

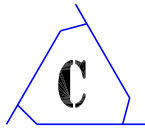

# INSERTED STICK TOOL TOOLHOLDERS

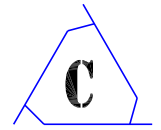

## TOOLING FOR CNC & SWISS TYPE MACHINES

SEE PAGES 23, 23L, 24, 24L AND 25 FOR INSERTS

R.H. TOOLHOLDERS	L.H. TOOLHOLDERS	"A"	"B"	SCREW	WRENCH
SWAR-10	SWAL-10	.312	.312	CTD-3143	CTD-3343
SWAR-12	SWAL-12	.375	.375		
SWAR-14	SWAL-14	.437	.437		
SWAR-16	SWAL-16	.500	.500		
SWAR-20	SWAL-20	.625	.625		
SWAR-24	SWAL-24	.750	.750		
SWAR-8MM	SWAL-8MM	8MM	8MM		
SWAR-10MM	SWAL-10MM	10MM	10MM		
SWAR-12MM	SWAL-12MM	12MM	12MM		
SWAR-14MM	SWAL-14MM	14MM	14MM		
SWAR-16MM	SWAL-16MM	16MM	16MM		
SWAR-20MM	SWAL-20MM	20MM	20MM		
SWAR-24MM	SWAL-24MM	24MM	24MM		

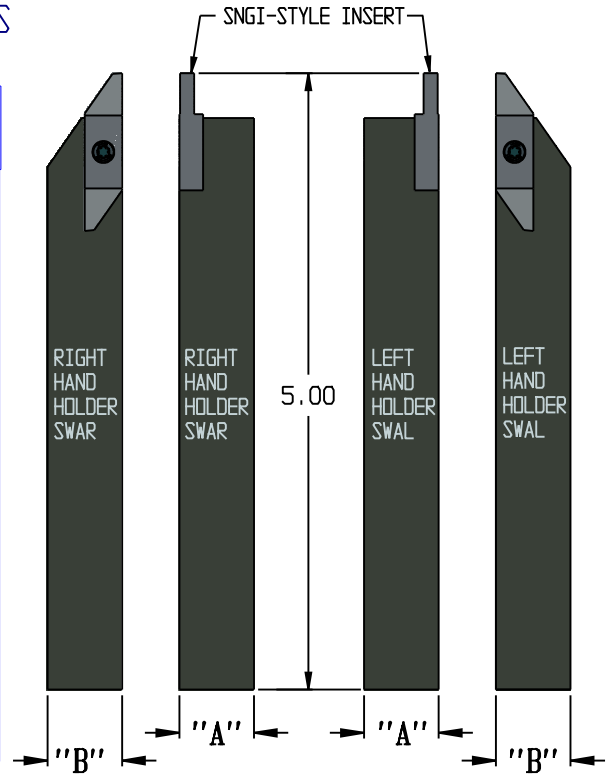

## "FOR DEEPER CUTS"

SEE PAGE 25 FOR INSERTS

R.H. TOOLHOLDERS	L.H. TOOLHOLDERS	"A"	"B"	SCREW	WRENCH
NGHR-16	NGHL-16	.500	.500	CTD-4110	CTD-4112
NGHR-20	NGHL-20	.625	.625		
NGHR-24	NGHL-24	.750	.750		
NGHR-32	NGHL-32	1.000	1.000		
NGHR-12MM	NGHL-12MM	12MM	12MM		
NGHR-14MM	NGHL-14MM	14MM	14MM		
NGHR-16MM	NGHL-16MM	16MM	16MM		
NGHR-20MM	NGHL-20MM	20MM	20MM		
NGHR-24MM	NGHL-24MM	24MM	24MM		

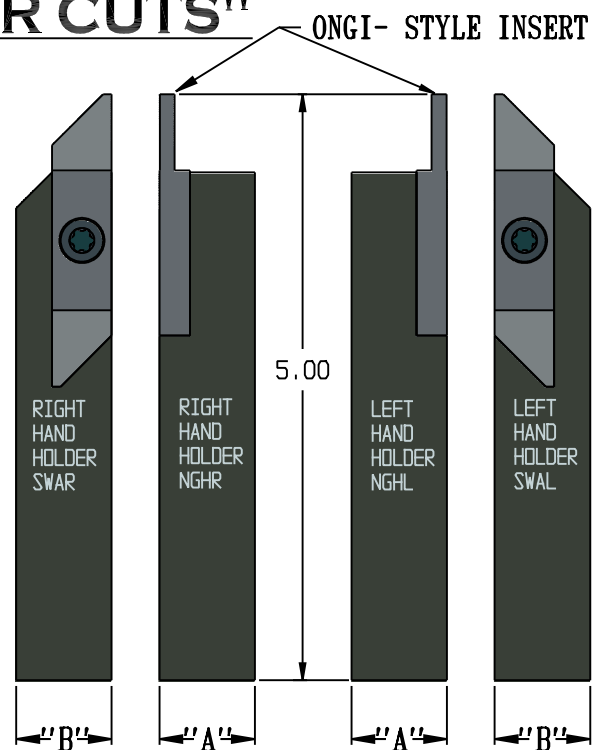

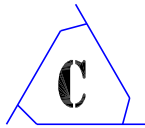

# CENTURY TOOL & DESIGN INC.

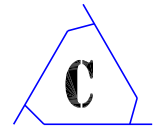

PATENT No. 7862261

## **WEDGE - LOC™**

A REGRINDABLE INSERT TOOLING SYSTEM

### **INSERTS & TOOLHOLDERS**

INSERT BLANK  
STYLE #1

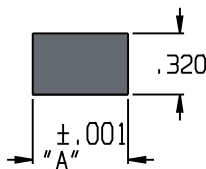

INSERT BLANK  
STYLE #2

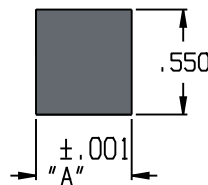

INSERT BLANK  
STYLE #3

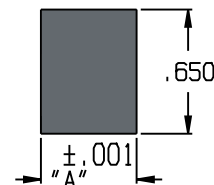

#### **ENLARGED VIEWS OF A FEW SPECIAL INSERT FORMS**

SUBMIT YOUR SPECIAL TOOLING REQUIREMENTS TO US TODAY FOR A QUOTATION USING THIS TYPE OF INSERT

THE INSERTS TOP SURFACE  
.120 MIN. REGRIND

OUTLINE OF THE UNIVERSAL SIDE PLATE

0° OR 5°  
.156 - STYLE No. 1  
.188 - STYLE No. 2 & 3

INSERT LOCATING SURFACES

WEDGE

HEX SOCKET  
BOTH ENDS

WEDGE LOCKING SCREW

HARDENED TOOL  
STEEL - SHANK

#### **BENEFITS:**

- 1) ALL INSERTS ARE REGRINDABLE.
- 2) THE INSERTS WILL ALWAYS RELOCATE BACK TO THE ORIGINAL POSITION.
- 3) THIS STYLE OF WEDGE-LOCKING SCREW AFFORDS EASY ACCESS FROM EITHER THE TOP OR THE FRONT.
- 4) MINIMUM DOWN TIME



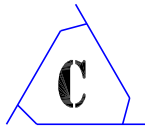

# **WEDGE - LOC™**

## **CNC & SWISS TYPE TOOLHOLDERS**

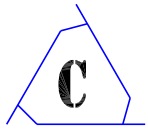

**PATENT No. 7862261**

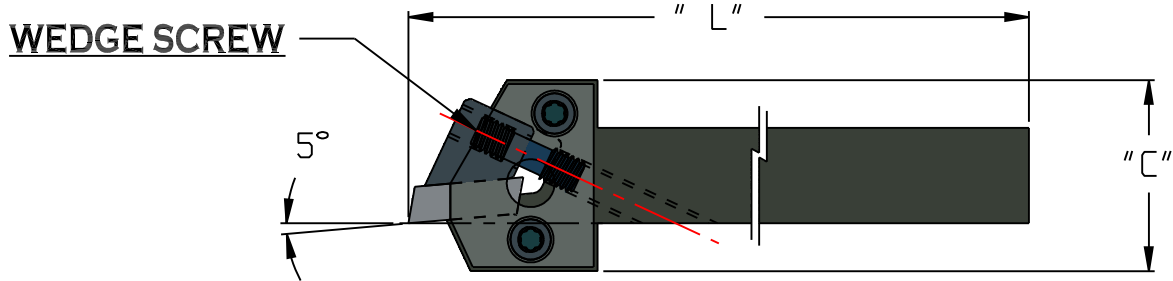

ORDERING EXAMPLE CTD-9131-375-4  
PAGE 29 AND 30

**TORX SCREW (2) REQ'D**  
**CTD-4110**

**UNIVERSAL SIDE PLATE (1) REQ'D**

ATTACHING THE SIDE PLATE TO THIS SIDE OF THE SHANK CREATES A RIGHT HAND TOOLHOLDER

**INSERT STYLE**  
**No. 1 OR No. 2**  
**PAGE #27**

ATTACHING THE SIDE PLATE TO THIS SIDE OF THE SHANK CREATES A LEFT HAND TOOLHOLDER

ORDERING EXAMPLE CTD-9130-375-4  
PAGES 29 AND 30.

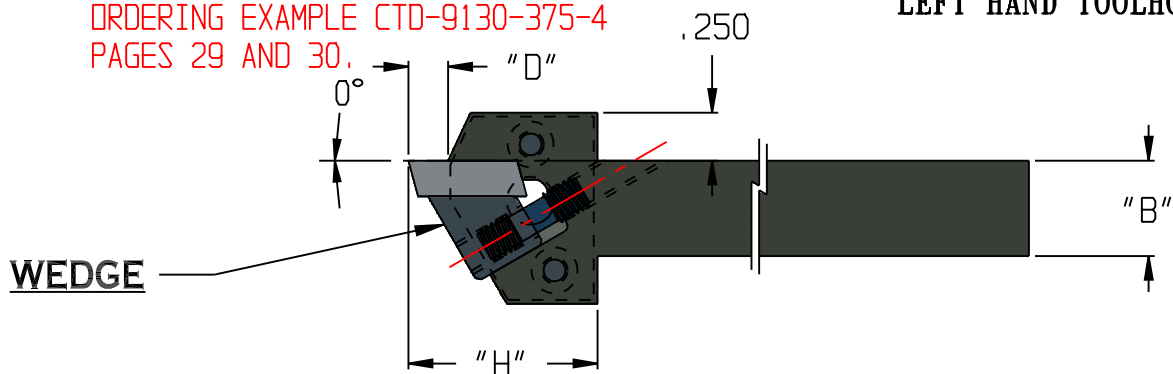

**FOR VARIATIONS OF THESE TOOLHOLDERS  
PLEASE SUBMIT YOUR REQUEST FOR A QUOTE**

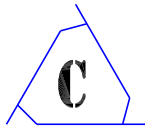

# WEDGE - LOC™

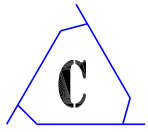

## CNC & SWISS TYPE TOOLHOLDERS

### PATENT No. 7862261

### TOOLHOLDER NUMBERS THAT USE STYLE No. 1 INSERTS

INSERTS ARE LOCATED ON PAGE #27

0° TOP RAKE TOOLHOLDERS	5° TOP RAKE TOOLHOLDERS	"A"	"B"	"C"	"D"	"H"	"L"	SIDE PLATE	WEDGE	WEDGE SCREW
CTD-9130-375-3	CTD-9131-375-3		.375					CTD-9130-SP	CTD-9128-375	CTD-9132
CTD-9130-375-4	CTD-9131-375-4		.500							
CTD-9130-375-5	CTD-9131-375-5	.375	.625	.875	.100	.75	4.0			
CTD-9130-375-10MM	CTD-9131-375-10MM		.394							
CTD-9130-375-12MM	CTD-9131-375-12MM		.472							
CTD-9130-375-14MM	CTD-9131-375-14MM		.551							

0° TOP RAKE TOOLHOLDERS	5° TOP RAKE TOOLHOLDERS	"A"	"B"	"C"	"D"	"H"	"L"	SIDE PLATE	WEDGE	WEDGE SCREW
CTD-9130-500-3	CTD-9131-500-3		.375					CTD-9130-SP	CTD-9128-500	CTD-9132
CTD-9130-500-4	CTD-9131-500-4		.500							
CTD-9130-500-5	CTD-9131-500-5	.500	.625	.875	.100	.75	4.0			
CTD-9130-500-10MM	CTD-9131-500-10MM		.394							
CTD-9130-500-12MM	CTD-9131-500-12MM		.472							
CTD-9130-500-14MM	CTD-9131-500-14MM		.551							

0° TOP RAKE TOOLHOLDERS	5° TOP RAKE TOOLHOLDERS	"A"	"B"	"C"	"D"	"H"	"L"	SIDE PLATE	WEDGE	WEDGE SCREW
CTD-9130-625-3	CTD-9131-625-3		.375					CTD-9130-SP	CTD-9128-625	CTD-9132
CTD-9130-625-4	CTD-9131-625-4		.500							
CTD-9130-625-5	CTD-9131-625-5	.625	.625	.875	.100	.75	4.0			
CTD-9130-625-10MM	CTD-9131-625-10MM		.394							
CTD-9130-625-12MM	CTD-9131-625-12MM		.472							
CTD-9130-625-14MM	CTD-9131-625-14MM		.551							

**HOLDERS LISTED ON PAGES 29, 30 AND 31 ARE COMMON SIZES.  
IF YOU DON'T SEE WHAT YOU REQUIRE, CALL, AND WE WILL  
DESIGN ONE FOR YOU.**

**HOLDERS THAT ARE DESIGNED FOR YOUR SPECIFIC APPLICATIONS  
WILL BE ISSUED ITS OWN CTD-NUMBER.**

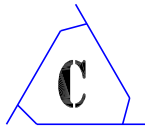

# WEDGE - LOC™

## CNC & SWISS TYPE TOOLHOLDERS

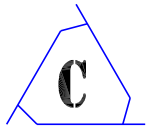

### PATENT No. 7862261

### TOOLHOLDER NUMBERS THAT USE STYLE No. 2 INSERTS

INSERTS ARE LOCATED ON PAGE #27

0° TOP RAKE TOOLHOLDERS	5° TOP RAKE TOOLHOLDERS	"A"	"B"	"C"	"D"	"H"	"L"	SIDE PLATE	WEDGE	WEDGE SCREW
CTD-8790-375-3	CTD-8791-375-3		.375					CTD-8790-SP	CTD-8766-375	CTD-8792
CTD-8790-375-4	CTD-8791-375-4		.500							
CTD-8790-375-5	CTD-8791-375-5		.625							
CTD-8790-375-6	CTD-8791-375-6		.750							
CTD-8790-375-10MM	CTD-8791-375-10MM	.375	.394	1.000	.200	.990	5.0			
CTD-8790-375-12MM	CTD-8791-375-12MM		.472							
CTD-8790-375-14MM	CTD-8791-375-14MM		.551							
CTD-8790-375-16MM	CTD-8791-375-16MM		.630							
CTD-8790-500-3	CTD-8791-500-3		.375					CTD-8790-SP	CTD-8766-500	CTD-8792
CTD-8790-500-4	CTD-8791-500-4		.500							
CTD-8790-500-5	CTD-8791-500-5		.625							
CTD-8790-500-6	CTD-8791-500-6		.750							
CTD-8790-500-10MM	CTD-8791-500-10MM	.500	.394	1.000	.200	.990	5.0			
CTD-8790-500-12MM	CTD-8791-500-12MM		.472							
CTD-8790-500-14MM	CTD-8791-500-14MM		.551							
CTD-8790-500-16MM	CTD-8791-500-16MM		.630							
CTD-8790-625-3	CTD-8791-625-3		.375					CTD-8790-SP	CTD-8766-625	CTD-8792
CTD-8790-625-4	CTD-8791-625-4		.500							
CTD-8790-625-5	CTD-8791-625-5		.625							
CTD-8790-625-6	CTD-8791-625-6		.750							
CTD-8790-625-10MM	CTD-8791-625-10MM	.625	.394	1.000	.200	.990	5.0			
CTD-8790-625-12MM	CTD-8791-625-12MM		.472							
CTD-8790-625-14MM	CTD-8791-625-14MM		.551							
CTD-8790-625-16MM	CTD-8791-625-16MM		.630							
CTD-8790-750-3	CTD-8791-750-3		.375					CTD-8790-SP	CTD-8766-750	CTD-8792
CTD-8790-750-4	CTD-8791-750-4		.500							
CTD-8790-750-5	CTD-8791-750-5		.625							
CTD-8790-750-6	CTD-8791-750-6		.750							
CTD-8790-750-10MM	CTD-8791-750-10MM	.750	.394	1.000	.200	.990	5.0			
CTD-8790-750-12MM	CTD-8791-750-12MM		.472							
CTD-8790-750-14MM	CTD-8791-750-14MM		.551							
CTD-8790-750-16MM	CTD-8791-750-16MM		.630							

# WEDGE - LOC™

## B & S AND DAVENPORT TOOLHOLDERS

### SPECIAL ORDER #00 B & S TOOLHOLDERS

**PATENT No. 7862261**

**INSERT STYLE #2**  
LOCATED ON PAGE #27

**CTD-8770-SP UNIVERSAL SIDE PLATE (1) REQ'D**

**CTD-8792 WEDGE SCREW**

**CTD-8237 TORX SCREW (4) REQ'D**

**WE ALSO SUPPLY HOLDERS AND INSERTS FOR #0 AND #2 BROWN & SHARPS**

TOOLHOLDERS	"A"	WEDGE No.
CTD-8770-375	.375	CTD-8766-375
CTD-8770-500	.500	CTD-8766-500
CTD-8770-625	.625	CTD-8766-625
CTD-8770-750	.750	CTD-8766-750

### DAVENPORT TOOLHOLDERS

**PATENT No. 7862261**

**INSERT STYLE #3**  
LOCATED ON PAGE #27

**CTD-8780-SP SIDE PLATE**

**CTD-8237 TORX SCREW (4) REQ'D**

**CTD-8646 WEDGE SCREW**

STANDARD HOLDER	"A"	WEDGE No.
CTD-8780-500	.500	CTD-8767-500
SPECIAL ORDER HOLDERS		WEDGE No.
CTD-8780-375	.375	CTD-8767-375
CTD-8780-625	.625	CTD-8767-625
CTD-8780-750	.750	CTD-8767-750

**FOR VARIATIONS OF THESE TOOLHOLDERS  
PLEASE SUBMIT YOUR REQUEST FOR A QUOTE**

**TM**  
**WEDGE-LOC INSERTS & TOOLHOLDERS**

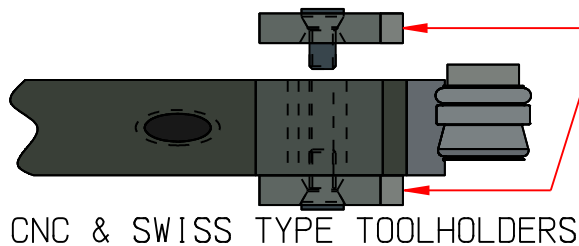

CNC & SWISS TYPE TOOLHOLDERS

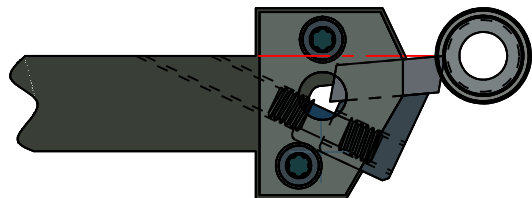

SEE PAGES 28,29 AND 30

SIDE PLATE CAN BE USED ON BOTH SIDES FOR MOST TOOLHOLDERS.

OUR PATENTED TECHNOLOGY CAN BE APPLIED TO ANY TOOLHOLDER.

ONCE THE TOOLHOLDER IS SET UP, MAKING DIFFERENT PARTS IS AS EASY AS CHANGING THE INSERT.

INSERT IS LOCKED IN BY THE WEDGE, WHICH CAN BE ACCESSED FROM FRONT OR BACK. THIS AIDS IN CHANGING INSERT.

BROWN & SHARP AND  
 DAVENPORT TOOLHOLDERS

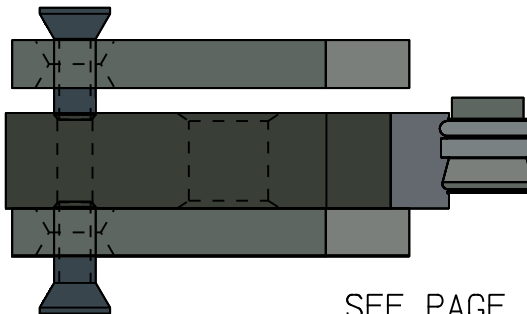

SEE PAGE 31.

OUR DESIGN STAFF WILL WORK CLOSELY WITH YOU TO PRODUCE INSERTS FOR YOUR PARTS.

WE WILL WORK TO MINIMIZE THE NUMBER OF OPERATIONS, HELPING WITH PRODUCTION.

ALL INSERTS HAVE A SPECIAL TOP FINISH FOR IMPROVED PART FINISH.

INSERTS ARE OFFERED IN DIFFERENT GRADES OF CARBIDE OR HIGH SPEED STEEL. INSERT COATINGS AND GRADE IS DEPENDENT ON YOUR PART MATERIAL AND TURNING SPEED.

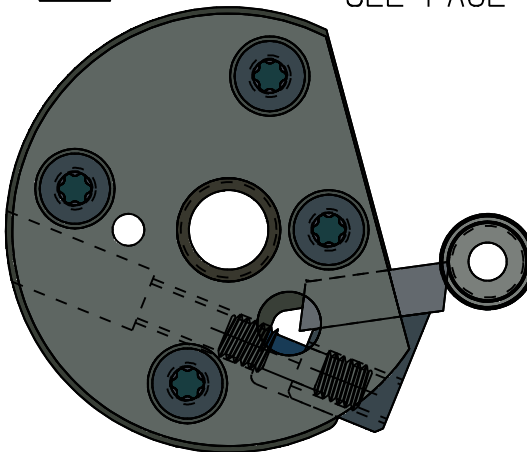

DOVETAILED TOOLHOLDER

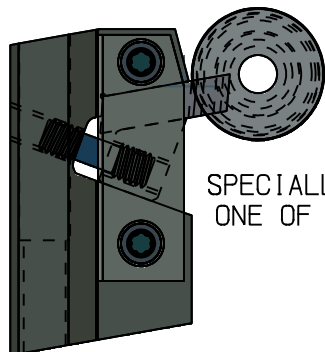
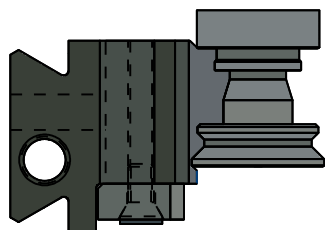

SPECIALLY DESIGNED FOR ONE OF OUR CUSTOMERS.

FOR A FRACTION OF THE COST OF NEW, OUR REGRIND SERVICE REMOVES ANY WEAR AND REAPPLIES SPECIAL FINISH. THE INSERT IS THEN RECOATED.

DUE TO OUR PATENTED DESIGN, INSERTS NEW OR REGROUND WILL LOCATE BACK TO CENTER HEIGHT AND LENGTH.

**PATENT No. 7862261**

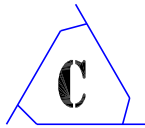

# INSERTED DOVETAIL TOOLHOLDERS

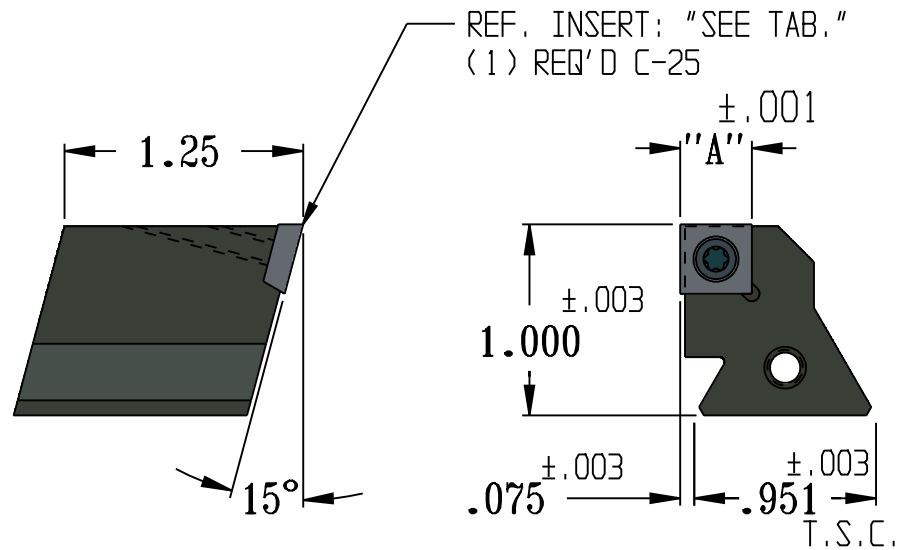
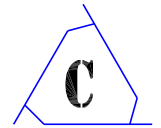

"A"	INSERT NUMBER	NUMBER OF CUTTING EDGES	TOOLHOLDER NUMBER	SCREW No.	WRENCH No.
.375	CTD-8516-375	(4)	CTD-8515-375	CTD-4110	CTD-4112
.500	CTD-8516-500	(4)	CTD-8515-500	CTD-4111	CTD-4112

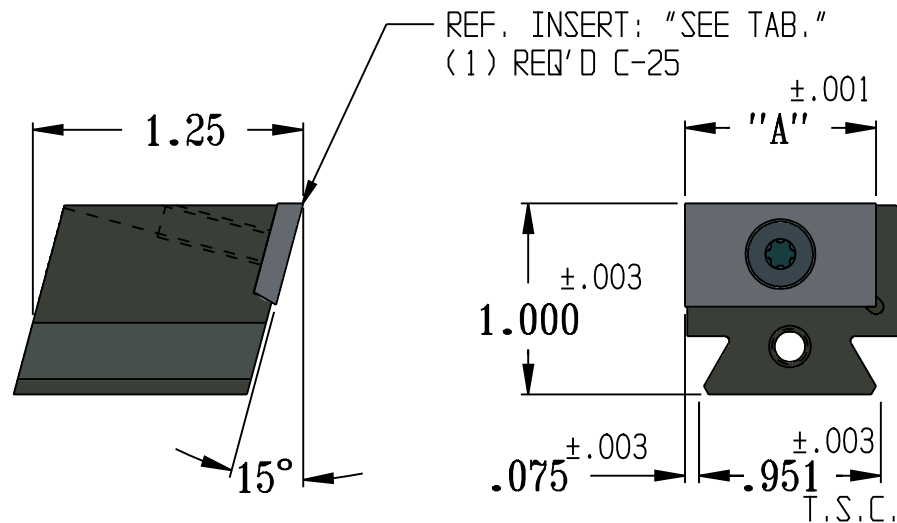

"A"	INSERT NUMBER	NUMBER OF CUTTING EDGES	TOOLHOLDER NUMBER	SCREW No.	WRENCH No.
.750	CTD-8516-750	(2)	CTD-8515-750	CTD-4857	CTD-3619
1.000	CTD-8516-1.000	(2)	CTD-8515-1.000	CTD-4857	CTD-3619



**ENLARGED VIEWS OF A FEW SPECIAL INSERT FORMS**

**DEPENDING ON FORM, INSERTS MAY BE SINGLE ENDED.**

**SUBMIT YOUR SPECIAL TOOLING REQUIREMENTS TO US TODAY FOR A QUOTATION USING THIS STYLE OF INSERT**

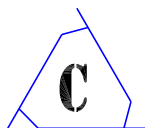

# STANDARD INSERTS

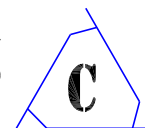

## DOGBONE INSERTS - STANDARD FLAT TOP - 1.125 O.A.L.

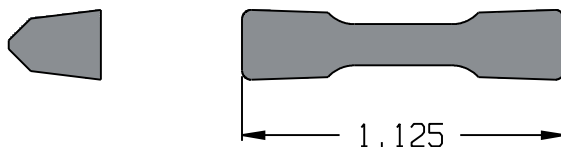

INSERT No. & GRADE	WIDTH	RADIUS	HEIGHT	GRADE	
.094 FR	C2 DR C5	.094	FULL RAD.	.250	C2 DR C5
.100 FR	C2 DR C5	.100	FULL RAD.	.250	C2 DR C5
.100 x .015R	C2 DR C5	.100	0.015	.250	C2 DR C5
.125 FR	C2 DR C5	.125	FULL RAD.	.250	C2 DR C5
.125 x .015R	C2 DR C5	.125	0.015	.250	C2 DR C5
.156 FR	C2 DR C5	.156	FULL RAD.	.250	C2 DR C5
.156 x .015R	C2 DR C5	.156	0.015	.250	C2 DR C5
.187 FR	C2 DR C5	.187	FULL RAD.	.250	C2 DR C5
.187 x .015R	C2 DR C5	.187	0.015	.250	C2 DR C5
.187 x .031R	C2 DR C5	.187	0.031	.250	C2 DR C5
.250 FR	C2 DR C5	.250	FULL RAD.	.338	C2 DR C5
.250 x .015R	C2 DR C5	.250	0.015	.338	C2 DR C5
.250 x .031R	C2 DR C5	.250	0.031	.338	C2 DR C5
.250 x .062R	C2 DR C5	.250	0.062	.338	C2 DR C5
.312 FR	C2 DR C5	.312	FULL RAD.	.338	C2 DR C5
.312 x .015R	C2 DR C5	.312	0.015	.338	C2 DR C5
.375 FR	C2 DR C5	.375	FULL RAD.	.338	C2 DR C5
.375 x .015R	C2 DR C5	.375	0.015	.338	C2 DR C5

SPECIAL FORMS QUOTED ON REQUEST

## TRIANGULAR INSERTS - SQUARE INSERTS - DIAMOND INSERTS

INSERT NUMBER & GRADE	INSERT NUMBER & GRADE
TPG-221 C2	TPG-321 & 322 TIN-COAT
TPG-222 C2	TPG-431, 432, 433, 434, 435 & 436 C2
TPG-321, 322, 323 & 324 C2	TPG-431, 432 & 433 C5
TPG-321, 322 & 323 C5	TPG-431, 432 & 436 TIN-COAT

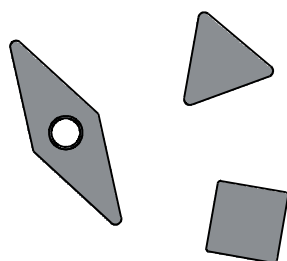

INSERT NUMBER & GRADE
SPG-321 & 322 C2
SPG-420, 421, 422, 423 & 424 C2
SPG-420, 421, 422 & 423 C5
SPG-420, 421, 422 & 424 TIN-COAT
CPG-421, 422 & 423 C2
CNMG-431, 432 & 433 C2
CNMG-431, 432 & 433 TIN-COAT
TNMG-432 & 433 C2
VNMA-331 & 332 C2
VNMG-331 & 332 C2

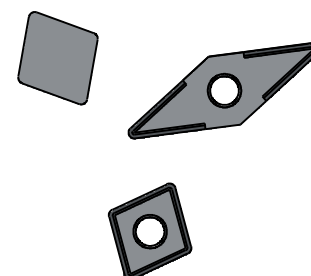

CALL OR FAX FOR PRICING ON ANY STANDARD INSERT YOU MAY REQUIRE  
WE OFFER DESIGN AND BUILD ON TOOLHOLDER AND INSERT PACKAGES  
PLUS CAD DRAWING PROPOSALS FROM YOUR PART PRINTS.

# SUPPLYING TOOLS



## AROUND THE WORLD

ALL ITEMS IN THIS CATALOG MAY BE LIMITED IN QUANTITY.  
TO SECURE ON TIME DELIVERY, BLANKET ORDERS ARE AVAILABLE.

NOTE THAT ALL ORDERS MUST COMPLY WITH OUR 10 PERCENT,  
OVER AND UNDER SHIPPING POLICY. WE HAVE A MINIMUM  
ORDER POLICY. \$100.00 ON INSERTS AND \$50.00 ON COMPONENT  
PARTS. HOLDER ORDERS HAVE NO MINIMUM.

IF YOU CHOOSE TO RETURN UNUSED INSERTS AND HOLDERS A  
RESTOCKING FEE WILL BE APPLIED. THIS FEE IS PER LINE ITEM,  
AND WILL BE DETERMINED BY OUR OFFICE.

CANCELED ORDERS , ONCE IN PROCESS, WILL BE ISSUED A FEE EQUAL  
TO COST OF MATERIAL AND LABOR AT POINT OF CANCELLATION.